

Sea Ray 

Specific
Information
Manual

250 Select EX



Manual Part Number: MRP 1902268

250 SELECT EX SPECIFIC INFORMATION MANUAL

TABLE OF CONTENTS

1. Load Capacity	1
2. Passenger Locations	1
3. Safety Label Locations	2
4. Basic Boat Dimensions and Clearances	3
5. Function and Location of Through-Hull Cutouts	4
6. Helm, Gauge & Switch Layout.....	5
7. Deck Layout	6
8. Cleats.....	7
9. Navigation and Anchor Lights.....	7
10. Bilge Layout	8
11. Fuel Layout	8
11. Fuel System.....	9
12. Canvas.....	9
13. Entertainment System	9
14. Water Sports Tower.....	9
15. Electrical Schematic	9

Information in this publication is based upon the latest product specifications available at printing. Sea Ray® Boats, Inc. reserves the right to make changes at any time, without notice, in the colors, equipment, specifications, materials and prices of all models, or to discontinue models. Should changes in production models be made, Sea Ray® is not obligated to make similar changes or modifications to models sold prior to the date of such changes.

Owner's Manual
250 Select Ex

Printed in the U.S.A. June 2008

© Sea Ray Boats, Inc. • A Brunswick Company
Sea Ray Boats, Inc. 2600 Sea Ray Blvd., Knoxville, TN 37914
For information call 1-800-SRBOATS or fax 1-314-213-7878
(International 1-314-216-3333)

Internet Address: <http://www.searay.com>

Note: Not all accessories shown in pictures or described herein are
standard equipment or even available as options.
Options and features are subject to change without notice.

The following are registered trademarks of the Brunswick Corporation: Sea Ray® & The SR Wave Logo

Sea Ray 



THIS PAGE INTENTIONALLY LEFT BLANK



250 SELECT EX OWNERS MANUAL

1. LOAD CAPACITY

Refer to the General Information Manual for a detailed explanation of Load Capacity.

! DANGER

Never carry more weight or passengers than indicated on the certification plate, regardless of weather or water conditions.

The boat can capsize, swamp or sink.

BUILDER'S PLATE (INTERNATIONAL)
(FIG. 1.1)

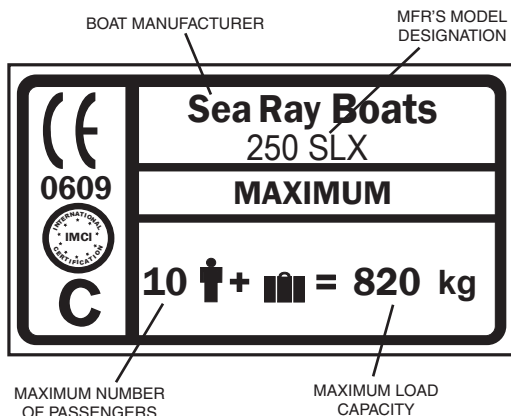

2. PASSENGER LOCATIONS

Refer to the General Information Manual for a detailed explanation of Passenger Locations.

! WARNING

Boat motion can be erratic.

You can fall overboard or be injured by hitting something in or on the boat.

All persons must be in cockpit area or cabin and be prepared for sudden boat movement.

Use front or bow deck area only during anchoring, mooring or emergencies.

! WARNING

Wet decks are slippery.

You can be seriously injured if you slip and fall.

Wear slip resistant footwear secured to your feet and hold on to rails or boat structure.

PASSENGER LOCATIONS
(FIG. 1.2)

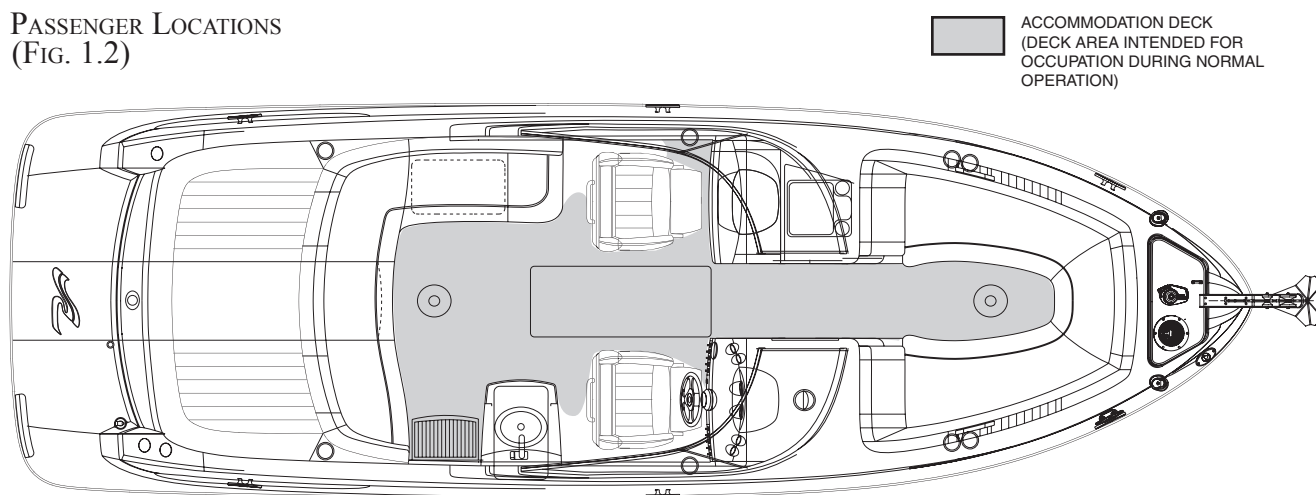

! WARNING

Rear facing transom seats be used while engine is running or boat is moving.

! DANGER

Rotating propellers can injure or kill you.

Shut off engine when persons are in water near boat, or on swim platform or ladder.



250 SELECT EX OWNERS MANUAL

3. SAFETY LABEL LOCATIONS

SAFETY LABEL LOCATIONS (FIG. 2.1)

! DANGER
Carbon Monoxide (CO) can cause brain damage or death.
Engine and generator exhaust contains odorless and colorless carbon monoxide gas.
Signs of carbon monoxide poisoning include nausea, headache, dizziness, drowsiness, and lack of consciousness.
Get fresh air if anyone shows signs of carbon monoxide poisoning.
See Owner's manual for information regarding carbon monoxide poisoning.

Sea Ray Boats
250 SLX
MAXIMUM
10 = 820 kg

Save Our Seas
It is illegal to dump plastic trash anywhere into the ocean or navigable waters of the United States. Violation of these requirements may result in civil penalty up to \$25,000, a fine of \$50,000 and imprisonment for up to five years.

PLASTIC - Includes but is not limited to: plastic bags, styrofoam cups and lids, six-pack holders, straws, straw, milk jugs, egg cartons, synthetic fishing nets, ropes, lines, and bits or photo degradable plastics.	INSIDE 3 MILES (and in U.S. Lakes, Rivers, Bays and Sounds) PLASTICS DUNNAGE, LINING AND PACKING MATERIALS THAT FLOAT ANY GARBAGE EXCEPT DISHWASHER DRAINAGE/FRESH FISH PARTS 3 TO 12 MILES PLASTICS DUNNAGE, LINING AND PACKING MATERIALS THAT FLOAT ANY GARBAGE NOT GROUND TO LESS THAN ONE SQUARE INCH 12 TO 25 MILES PLASTICS DUNNAGE, LINING AND PACKING MATERIALS THAT FLOAT 12 TO 25 MILES PLASTICS	DUNNAGE - Material used to block and brace cargo, and is considered a cargo associated waste. DISHWASHER - Means the liquid residue from the manual or automatic washing of dishes and cooking utensils which, have been pre-cleaned to the extent that any food particles adhering to them would not normally interfere with the operation of automatic dishwashers. GRAYWATER - Means drainage from a dishwasher, shower, laundry, bath, and washbasin, and does not include drainage from toilets, urinals, hospitals, and cargo spaces.
--	--	---

CAUTION
IF SWITCH IS TURNED OFF WHILE ENGINE IS RUNNING, ALTERNATOR WILL BE DAMAGED.
MRP # 1746801 SR-7167
ON BATTERY SWITCH PANEL

WARNING
LEAKING FUEL IS A FIRE AND EXPLOSION HAZARD. INSPECT SYSTEM REGULARLY. EXAMINE FUEL TANKS FOR LEAKS OR CORROSION AT LEAST ANNUALLY.
MRP 1745513 SR-7151
LOCATED ON PORT SIDE WALL

NOTICE
CHECK BATTERY CELL FLUID LEVEL APPROXIMATELY EVERY 4 WEEKS, AND MORE OFTEN IN SUMMER AND HOT ZONES.
MRP # 1746895 SR-7139
LOCATED ON PORT SIDE WALL

DISCHARGE OF OIL PROHIBITED
THE FEDERAL WATER POLLUTION CONTROL ACT PROHIBITS THE DISCHARGE OF OIL OR GREASE INTO OR UPON THE NAVIGABLE WATERS OF THE UNITED STATES OR THE WATERS OF THE CONTIGUOUS IF SUCH DISCHARGE CAUSES A FUM OR STRESS UPON OR DISCOLORATION OF THE SURFACE OF THE WATER OR CAUSES A SLOTTED OR DISCOLORATION OF THE SURFACE OF THE WATER.
VIOLATORS ARE SUBJECT TO A FINE OF \$5,000.
LOCATED ON PORT SIDE WALL

DANGER
STAY CLEAR OF MOVING PARTS WHILE ENGINE IS RUNNING.
MRP 1745512 SR-7149
LOCATED ON PORT SIDE WALL

DANGER
NO SMOKING
GASOLINE VAPORS ARE EXPLOSIVE
NOTICE
GASOLINE RECOMMENDATION
Minimum octane rating of 87 AKI.
Refer to the engine owner's manual for additional information.
MRP 1745157 SR-7119A

DANGER
TO AVOID RISK OF SERIOUS INJURY OR DEATH SHUT OFF ENGINE WHEN NEAR SWIMMERS OR PRIOR TO USING SWIM PLATFORM AND BOARDING LADDER.
MRP 1745519 SR-7214

DANGER
CARBON MONOXIDE CAN BE FATAL. In all gasoline powered boats, engine exhaust systems produce colorless, odorless carbon monoxide gas (CO). Direct prolonged exposure can result in CO poisoning which may be harmful or fatal. To prevent excess exposure and reduce the possibility of accumulations of CO in the boat, the operator should include adequate ventilation through utilization of cabin hatches and walk-through windshields to increase air movement through the boat. The following conditions tend to increase the accumulation of CO in and about the boat and require the operator's particular attention:
• Operation at slow speeds or dead in water.
• Utilization of canvas tops, side curtains or back curtains.
• Any blockage of hull exhaust outlets.
• Contributing climatic conditions, such as headwinds.
• Operation with a high bow angle attitude.
• Operation of engines and/or generator in confined spaces or at dockside.
INDICATIONS OF EXCESSIVE EXPOSURE TO CO CONCENTRATIONS MAY INCLUDE NAUSEA, DIZZINESS, HEADACHE AND DROWSINESS.
AVOID RISK OF INJURY OR DEATH. SHUT OFF ENGINE NEAR SWIMMERS OR PRIOR TO USING SWIM PLATFORM, SUNPAD OR BOARDING LADDER.

WARNING
USE CAUTION WITH SKIER IN TOW AS ROPE MAY BACKLASH INTO COCKPIT WHEN RELEASED
AVOID COLLISIONS - Maintain lookout as required by "Rules of the Road". Visibility can be limited by high boat trim angles, persons and gear. Such issues are considered under the control of the operator.
NOTICE: It is recommended that all occupants wear approved Personal Flotation Devices (PFD's).

DANGER
STAY CLEAR OF MOVING PARTS
MRP # 1746896 SR-7162

WARNING
A wide variety of components used on this vessel contain or emit chemicals known to the state of California to cause cancer and birth defects and other reproductive harm.
EXAMPLES INCLUDE:
• Engine and generator exhaust
• Engine and generator fuel, and other liquids such as coolants and oil, especially used motor oil.
• Cleaning, painting, and substances used for vessel repair.
• Waste materials that result from wear of vessel components.
• Leaks from battery terminals and from other sources such as ballast or fishing slivers.
TO AVOID HARM:
• Keep away from engine, generator, and cooking fuel exhaust fumes.
• Wash areas thoroughly with soap and water after handling the substances above.
California Health & Safety Code § 25249.13

MRP 1798084
CALIFORNIA RESIDENTS ONLY
THE ABOVE WARNING IS ATTACHED TO THE STEERING WHEEL PRIOR TO DELIVERY OF ANY BOATS SOLD IN THE STATE OF CALIFORNIA IN ACCORDANCE WITH CALIFORNIA HEALTH & SAFETY CODE §§ 25249.5-13.

WARNING
GASOLINE VAPORS CAN EXPLODE RESULTING IN INJURY OR DEATH
BEFORE STARTING ENGINE: CHECK ENGINE COMPARTMENT BILGE FOR GASOLINE OR VAPORS. OPERATE BLOWER FOR FOUR MINUTES AND VERIFY BLOWER OPERATION.
RUN BLOWER WHEN VESSEL IS OPERATING BELOW CRUISING SPEEDS

FIRE PORT ACCESS UNDER
KEEP CLEAR
MRP #1743499 SR-7125

WARNING
IN CASE OF FIRE, DO NOT OPEN ENGINE BAY/COMPARTMENT
SHUT DOWN ENGINE, GENERATOR OR BLOWER
CONTRADICTORY THROUGH THE CONTENTS OF FUEL OR OIL FORMER THE ACTION ABOVE THROUGH PORT BARGE/WALKWAY

ONLY ON BOATS WITHOUT AN OPTIONAL AUTOMATIC FIRE SUPPRESSION SYSTEM

WARNING
USE CAUTION WITH SKIER IN TOW AS TOW ROPE MAY BACKLASH INTO COCKPIT WHEN RELEASED
MRP 1745125 SR-7111

DANGER
Carbon Monoxide (CO) can cause brain damage or death.
Engine and generator exhaust contains odorless and colorless carbon monoxide gas.
Carbon monoxide will be around the back of the boat when engines or generators are running.
Move to fresh air, if you feel nausea, headache, dizziness or drowsiness.



250 SELECT EX OWNERS MANUAL

4. BASIC BOAT DIMENSIONS AND CLEARANCES

BOAT DIMENSIONS AND CLEARANCES
(FIG. 3.1)

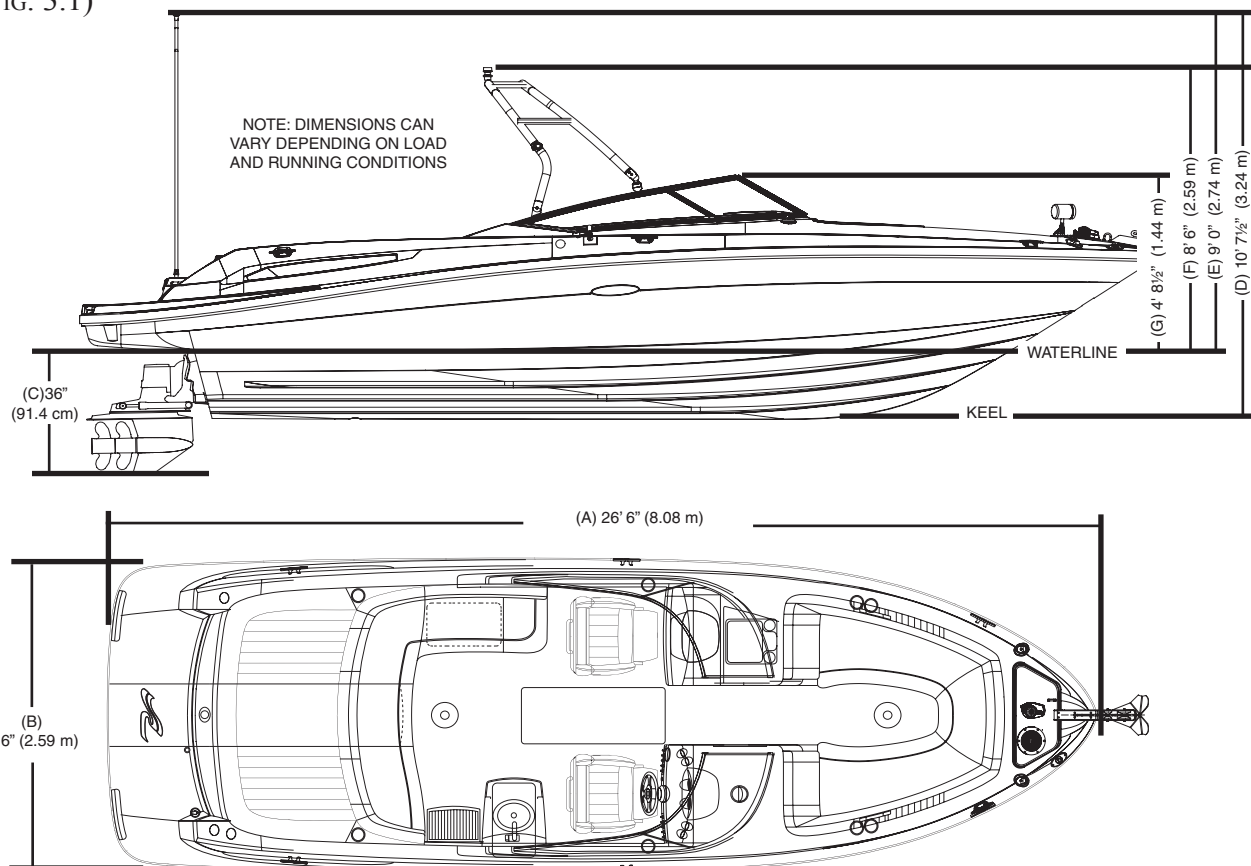

250 SELECT EX SPECIFICATIONS

(A) Overall Length		
With Std. Swim Platform.....	26ft. 6in.	8.08 m
(B) Beam (Width).....	8ft. 6in.	2.59 m
(C) Draft (Stern Drive Down)	36in.*	91.4 cm*
Draft (Stern Drive Up).....	20in.*	50.8 cm*

* MINIMUM WATER DEPTH TO PREVENT RUNNING AGROUND

Dry Weight.....	5,050 lbs.	2,290 kg.
Fuel Capacity.....	75 gal.	283.9 liters
Usable Fuel	67.5 gal.	255.5 liters
Fresh Water Capacity	21 gal.	79.5 liters
Dead Rise.....	21°	

HEIGHT DIMENSIONS

(D) Keel to Top of Stern Light*	10ft. 7½in.	3.24 m
(E) Waterline to Top of Stern Light*	9ft. 0in.	2.74 m
(F) Waterline to Top of Stern Light**	8ft. 6in.	2.59 m
(G) Waterline to Top of Windshield	4ft. 8½in.	1.44 m

* Removable stern light without Water Sports Tower option

** Fixed stern light with Water Sports Tower option

5. FUNCTION AND LOCATION OF THROUGH-HULL CUTOUTS

PORT THROUGH-HULL CUTOUTS
(FIG.4.1)

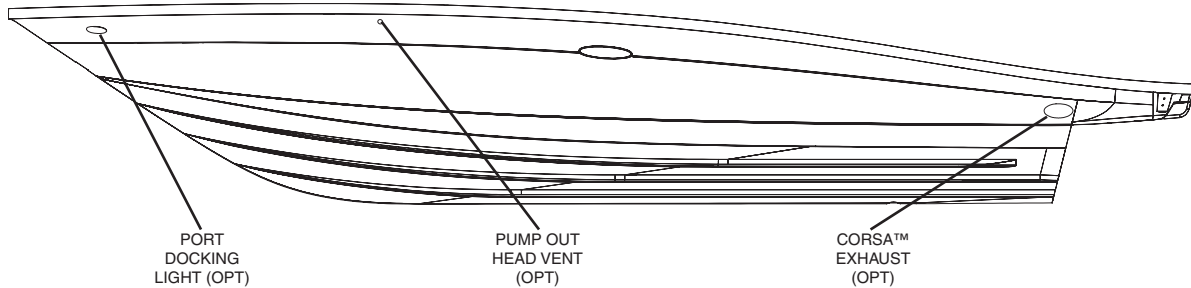

STARBOARD THROUGH-HULL CUTOUTS
(FIG.4.2)

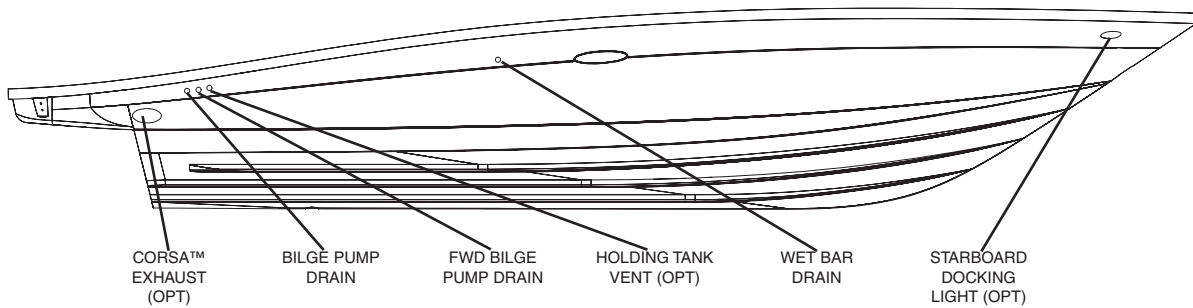

BILGE THROUGH-HULL CUTOUTS
(FIG.4.3)

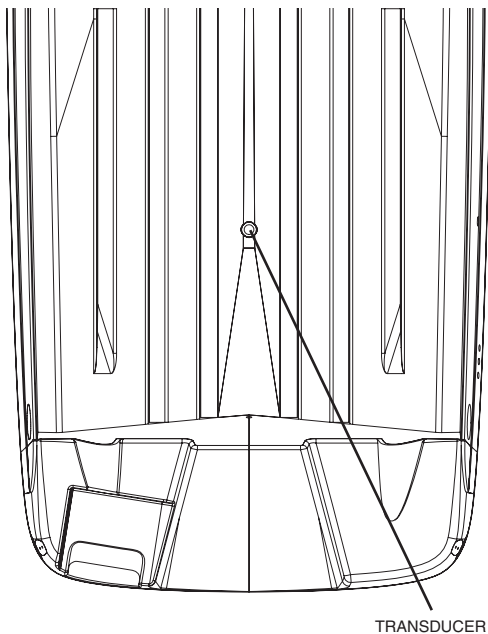

TRANSOM THROUGH-HULL CUTOUTS
(FIG.4.4)

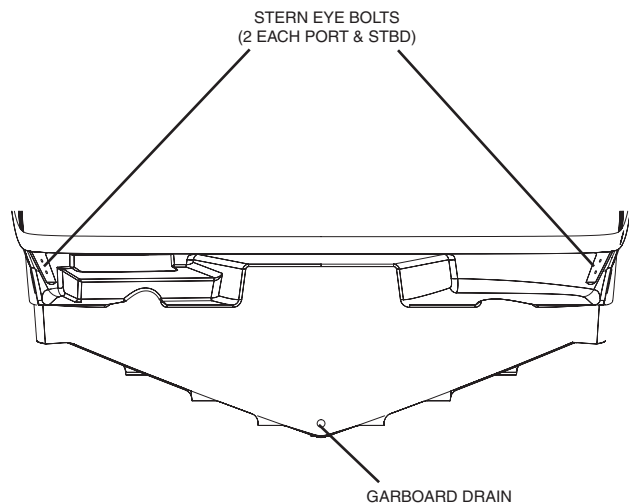

250 SELECT EX OWNERS MANUAL

6. HELM, GAUGE & SWITCH LAYOUT

HELM LAYOUT, (SHOWN W/ OPTIONAL CHART PLOTTER)
(FIG. 5.1)

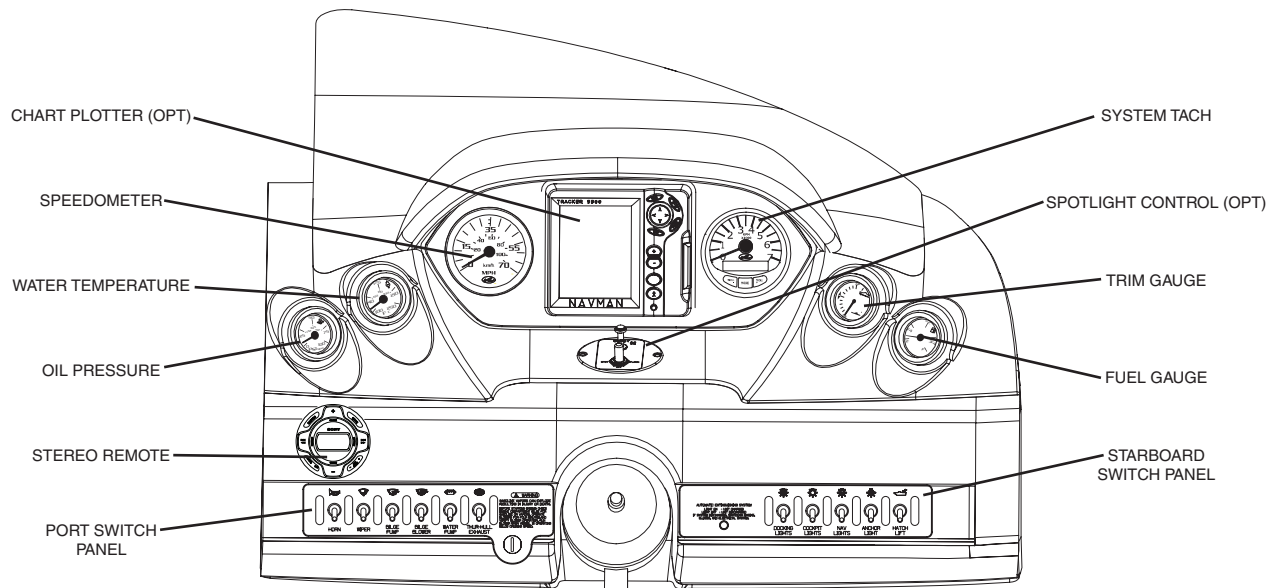

SWITCH PANELS
(FIG. 5.2)

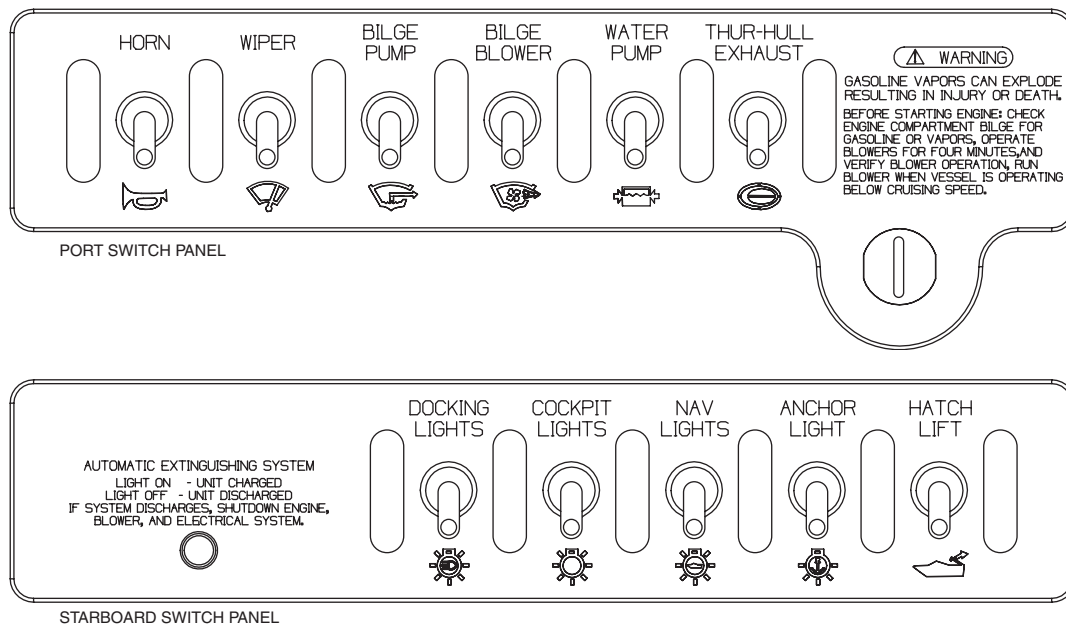

250 SELECT EX OWNERS MANUAL

7. DECK LAYOUT

GENERAL LAYOUT
(FIG. 6.1)

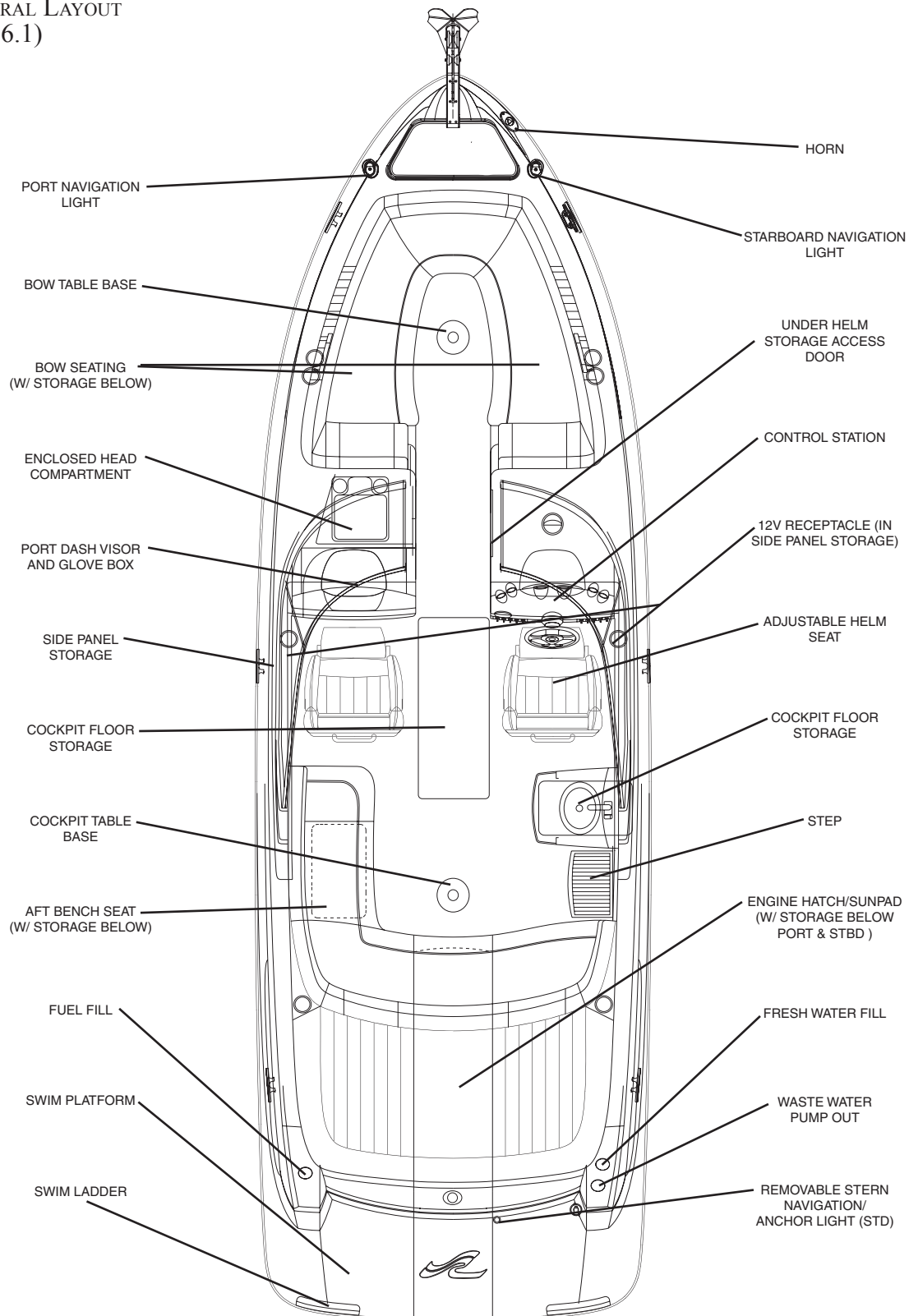

250 SELECT EX OWNERS MANUAL

8. CLEATS

Cleats must not be used for lifting the boat; they are intended for docking or mooring use only.

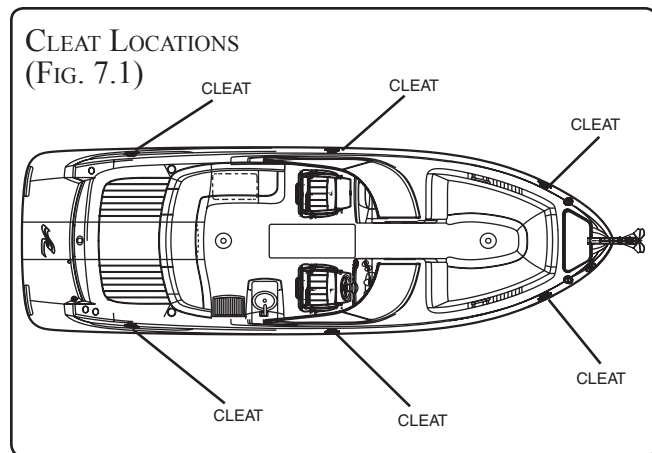

9. NAVIGATION AND ANCHOR LIGHTS

See General Information Manual for a detailed explanation of the anchor lights.

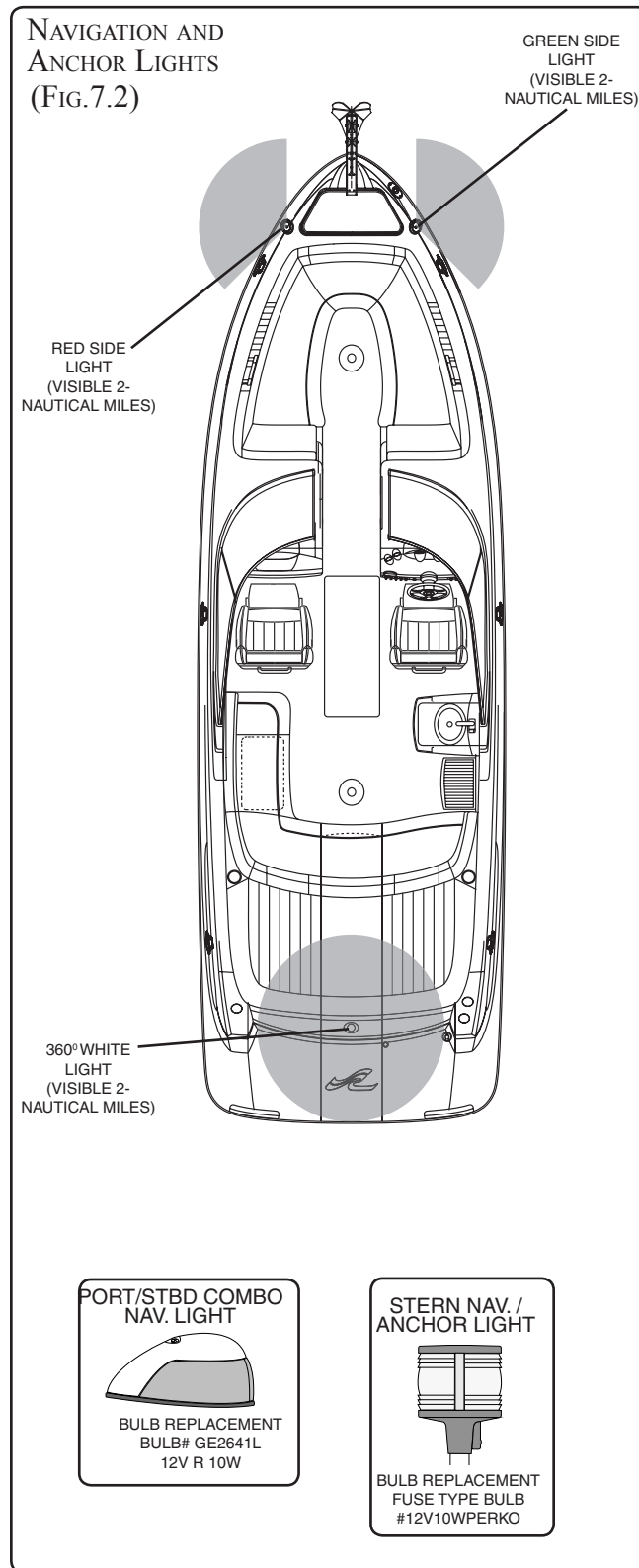

250 SELECT EX OWNERS MANUAL

10. BILGE LAYOUT

BILGE LAYOUT
(FIG. 8.1)

- (A) FWD SUMP FLOAT SWITCH
- (B) FRESH WATER PUMP
- (C) BATTERIES
- (D) TRIM TABS PUMP
- (E) POWER TRIM PUMP
- (F) AUTOMATIC FIRE EXTINGUISHER (OPT)
- (G) BILGE BLOWER
- (H) FRESH WATER TANK
- (I) FUEL TANK
- (J) TRANSDUCER
- (K) BILGE PUMP
- (L) HOLDING TANK VENT FILTER (OPT)
- (M) WASTE WATER HOLDING TANK (OPT)
- (N) BILGE FLOAT SWITCH

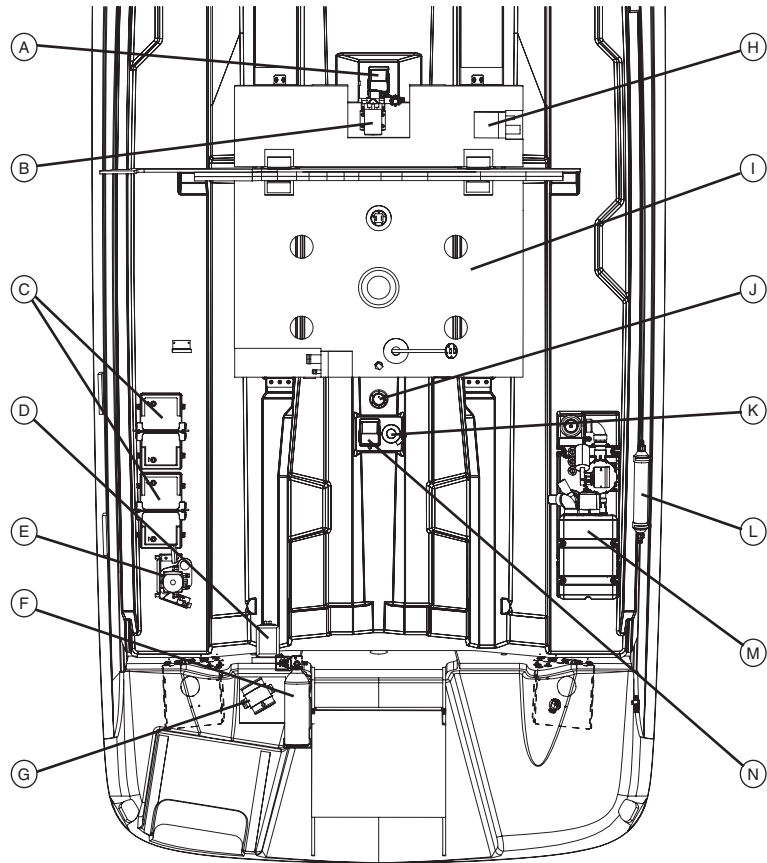

11. FUEL LAYOUT

STANDARD FUEL SYSTEM
(FIG. 8.2)

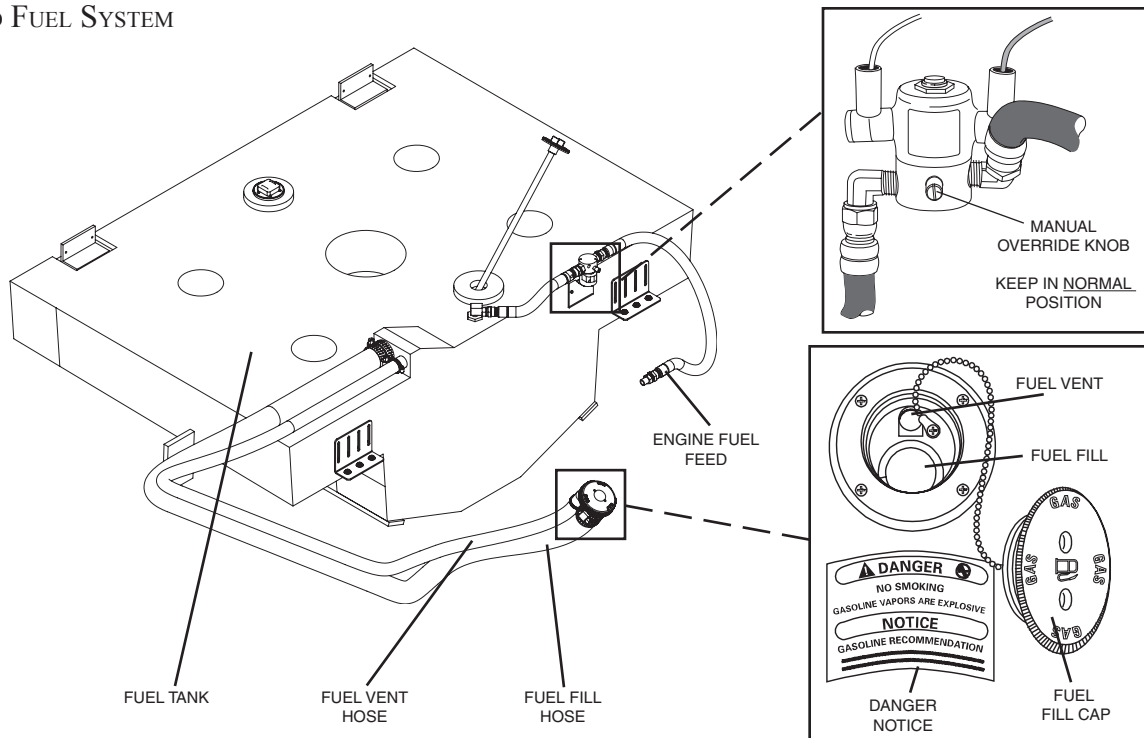

250 SELECT EX OWNERS MANUAL

11. FUEL SYSTEM

The 250 Select EX standard gasoline fuel system consists of a 75 gallon (284 liter) fuel tank, fuel tank vent, electric fuel valve, engine fuel supply line and fuel fill.

12. CANVAS

The following canvas pieces are available individually as options:

- Sunbrella® Bimini Top w/ Boot
- Cockpit and Tonneau Covers w/ storage Bag
- Travel/Storage Cover

13. ENTERTAINMENT SYSTEM

The 12 volt AM/FM radio single CD satellite ready stereo is located in the port dash.

The system includes six (6) water proof speakers, a subwoofer, a digital remote control located at the control station and an optional remote on the transom. An optional speaker system is available with the Water Sports Tower option.

14. WATER SPORTS TOWER

If equipped, the water sports tower provides a raised attach point (ski tow pylon) for the ski rope. The high attach point enables the skier to perform a wide variety of skills not capable with the lower transom attach point.

The tower attach point is intended for use only when towing a single skier. If you are towing multiple skiers or water toys carrying more than one person use only the transom attach point. The tower attach point is NOT intended for towing inflatables.

WARNING

DO NOT USE TOWER FOR PULLING INFLATABLES. Use water sports tower for single skier/wakeboarder only. Use ski tow or stern eyes on transom for all other tow behind sports. Heavy loads could collapse tower causing personal injury.

WARNING

DO NOT USE WATER SPORTS TOWER FOR TOWING ANOTHER BOAT OR BEING TOWED. TOWER COULD COLLAPSE AND CAUSE INJURY. SEE OWNER'S MANUAL FOR INSTRUCTIONS ON TOWING.

15. ELECTRICAL SCHEMATICS

This owner's manual contains electrical schematics and wiring harness illustrations for your boat. These electrical schematics were generated by electrical CAD designers at the engineering division for technical reference and service technicians. Sea Ray® does not recommend that you attempt to work on the boat's electrical system yourself. Instead, we recommend that you take your boat to your authorized Sea Ray® dealer for service. Sea Ray® reserves the right to change or update the electrical system on any model at any time without notice to the consumer and is NOT obligated to make any updates to units built prior to changes.

DC WIRING DIAGRAM (1 OF 3)
DRAWING NO. 09-601
(FIG. 11.1)

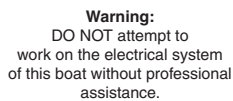

250 SELECT EX OWNERS MANUAL

DC WIRING DIAGRAM (3 OF 3)
DRAWING NO. 09-601
(FIG. 12.1)

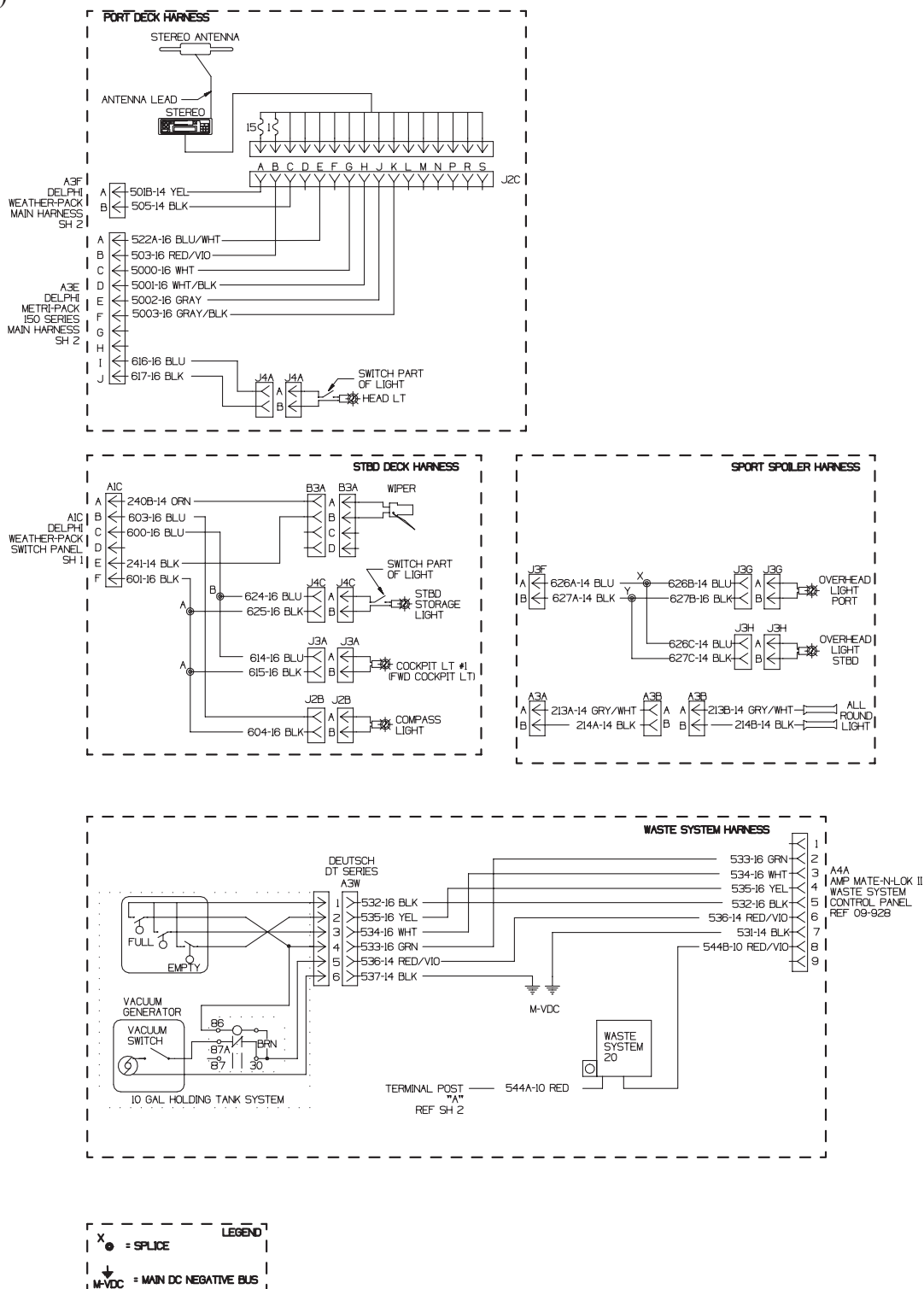

Warning:
DO NOT attempt to
work on the electrical system
of this boat without professional
assistance.



250 SELECT EX OWNERS MANUAL

AC SYSTEM WIRING DIAGRAM (120VAC)

DRAWING NO. 09-630

(FIG. 13.1)

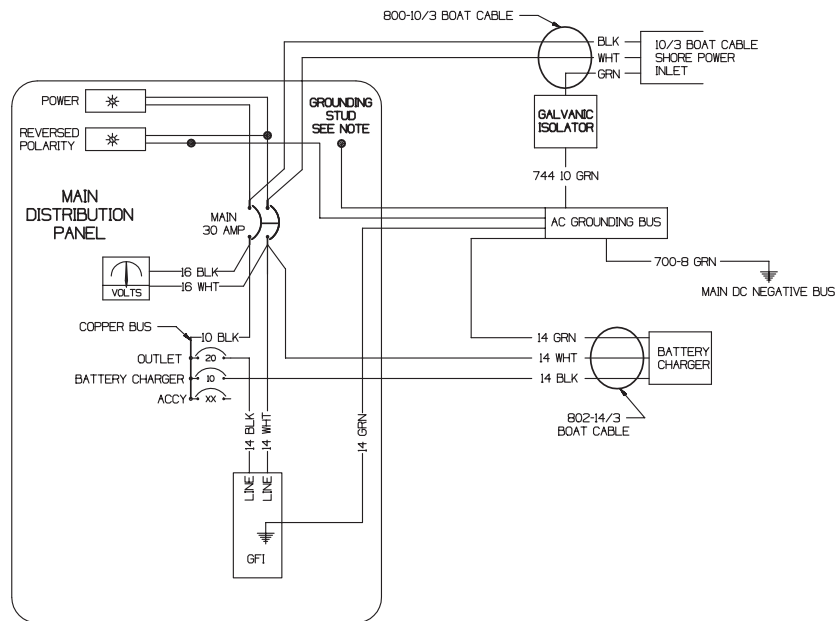

AC SYSTEM WIRING DIAGRAM (220VAC)

DRAWING NO. 09-632

(FIG. 13.2)

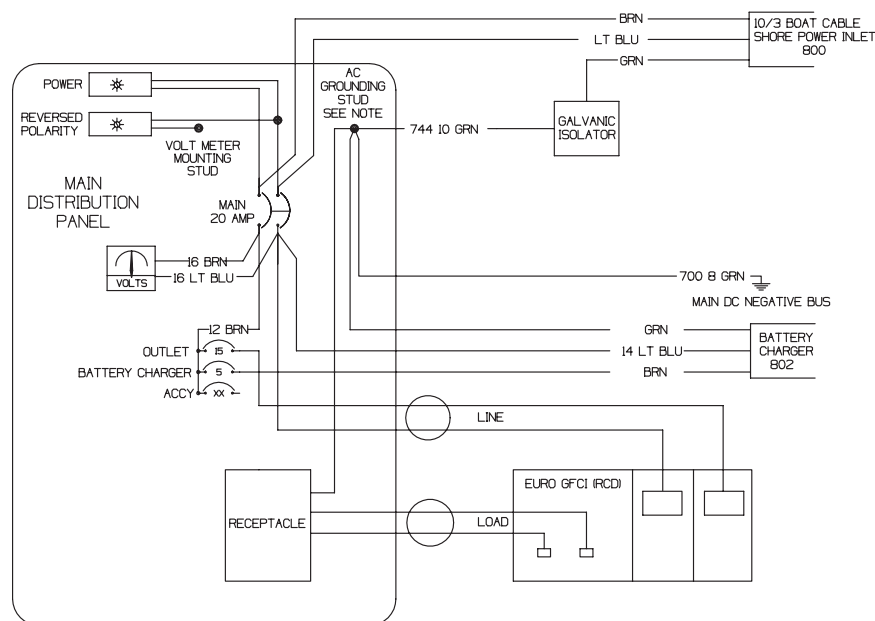

Warning:
DO NOT attempt to
work on the electrical system
of this boat without professional
assistance.

250 SELECT EX OWNERS MANUAL

THIS PAGE INTENTIONALLY LEFT BLANK



INDEX

A

Anchor Lights.....7

C

Canvas.....9

Clearances3

Cleats7

D

Deck Layout.....6

Dimensions.....3

E

Electrical Schematics9

F

Fuel System.....8

G

Gauge Layout5

H

Helm Layout.....5

N

Navigation Lights7

P

Passenger Locations1

S

Safety Label Locations2

T

Through-Hull Cutouts4

W

Water Sports Tower9

THIS PAGE LEFT INTENTIONALLY BLANK

