

*Sea Ray* 

Specific  
Information  
Manual

# 205 Sport



Manual Part Number: MRP 1902268



---

# 205 SPORT SPECIFIC INFORMATION MANUAL

---

## TABLE OF CONTENTS

1. Load Capacity.....	1
2. Passenger Locations .....	1
3. Safety Label Locations .....	2
4. Basic Boat Dimensions and Clearances .....	3
5. Function and Location of Through-Hull Cutouts .....	4
6. Helm, Gauge & Switch Layout.....	5
7. Deck Layout.....	6
8. Cleats.....	7
9. Navigation and Anchor Lights.....	7
10. Bilge Layout .....	7
11. Fuel System.....	7
12. Entertainment System .....	8
13. Canvas.....	8
14. Water Sports Tower.....	9
15. Swim Platform and Ladder .....	9
16. Electrical Schematic .....	9

Information in this publication is based upon the latest product specifications available at printing. Sea Ray® Boats, Inc. reserves the right to make changes at any time, without notice, in the colors, equipment, specifications, materials and prices of all models, or to discontinue models. Should changes in production models be made, Sea Ray® is not obligated to make similar changes or modifications to models sold prior to the date of such changes.

Owner's Manual  
205 Sport

Printed in the U.S.A. April 2007

© Sea Ray Boats, Inc. • A Brunswick Company  
Sea Ray Boats, Inc. 2600 Sea Ray Blvd., Knoxville, TN 37914  
For information call 1-800-SRBOATS or fax 1-314-213-7878  
(International 1-314-216-3333)

Internet Address: <http://www.searay.com>

Note: Not all accessories shown in pictures or described herein are standard equipment or even available as options.  
Options and features are subject to change without notice.

The following are registered trademarks of the Brunswick Corporation: Sea Ray® & The SR Wave Logo



THIS PAGE INTENTIONALLY LEFT BLANK



# 205 SPORT OWNERS MANUAL

## 1. LOAD CAPACITY

Refer to the General Information Manual for a detailed explanation of *Load Capacity*.

### ⚠ DANGER

Never carry more weight or passengers than indicated on the certification plate, regardless of weather or water conditions.

The boat can capsize, swamp or sink.

BUILDER'S PLATE (INTERNATIONAL)  
(FIG. 1.1)

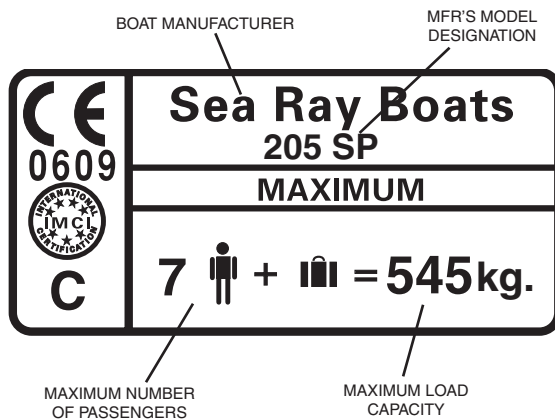

BUILDER'S PLATE (DOMESTIC)  
(FIG. 1.2)

MAXIMUM CAPACITIES
8 PERSONS OR 1100 LBS. 1200 POUNDS, PERSONS, GEAR
THIS BOAT COMPLIES WITH U.S. COAST GUARD SAFETY STANDARDS IN EFFECT ON THE DATE OF CERTIFICATION MANUFACTURER: SEA RAY BOATS, INC. VONORE, TN
MODEL: 205 Sport
DESIGN COMPLIANCE WITH NMMA REQUIREMENTS BELOW IS VERIFIED. MFR. RESPONSIBLE FOR PRODUCTION CONTROL
LOAD AND CAPACITY • COMPARTMENT VENTILATION STEERING, FUEL AND ELECTRICAL SYSTEMS INTERNATIONAL LIGHTS • BASIC FLOATATION MANEUVERABILITY
NATIONAL MARINE MANUFACTURERS ASSN.

## 2. PASSENGER LOCATIONS

Refer to the General Information Manual for a detailed explanation of *Passenger Locations*.

### ⚠ WARNING

Boat motion can be erratic.

You can fall overboard or be injured by hitting something in or on the boat.

All persons must be in cockpit area or cabin and be prepared for sudden boat movement.

Use front or bow deck area only during anchoring, mooring or emergencies.

### ⚠ WARNING

Wet decks are slippery.

You can be seriously injured if you slip and fall.

Wear slip resistant footwear secured to your feet and hold on to rails or boat structure.

PASSENGER LOCATIONS  
(FIG. 1.3)

ACCOMMODATION DECK  
(DECK AREA INTENDED FOR OCCUPATION DURING NORMAL OPERATION)

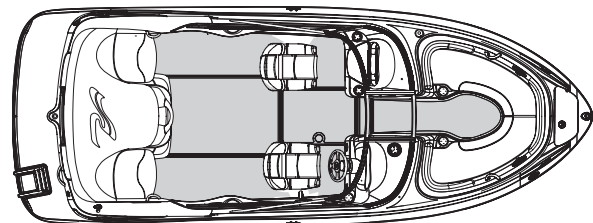

### ⚠ DANGER

Rotating propellers can injure or kill you.

Shut off engine when persons are in water near boat, or on swim platform or ladder.

### ⚠ WARNING

Rear facing transom seats **MUST NOT** be used while engine is running or boat is moving.



# 205 Sport Owners Manual

## 3. SAFETY LABEL LOCATIONS

SAFETY LABEL LOCATIONS  
(FIG. 2.1)

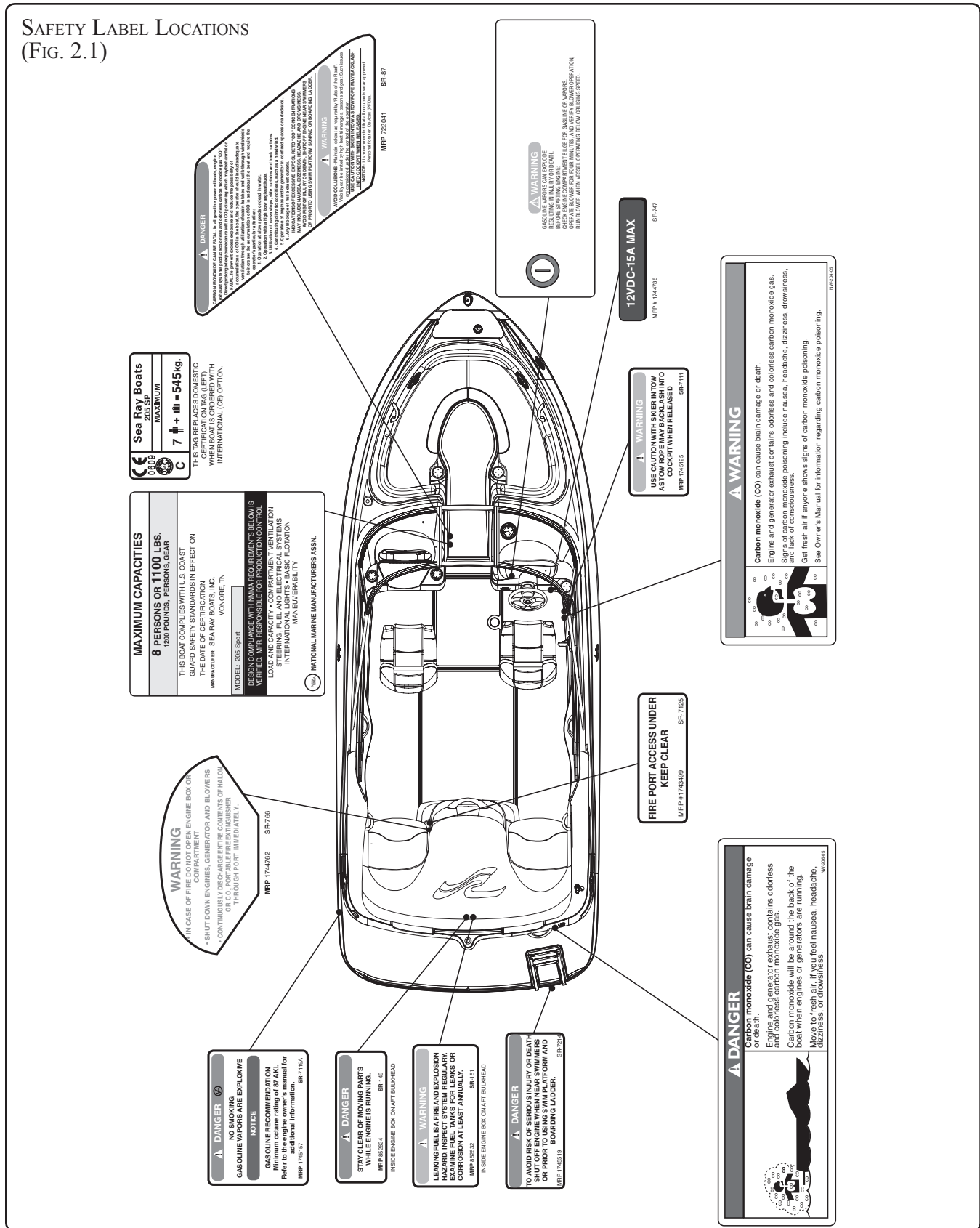

# 205 SPORT OWNERS MANUAL

## 4. BASIC BOAT DIMENSIONS AND CLEARANCES

BOAT DIMENSIONS AND CLEARANCES  
(FIG. 3.1)

NOTE: DIMENSIONS CAN VARY DEPENDING ON LOAD AND RUNNING CONDITIONS

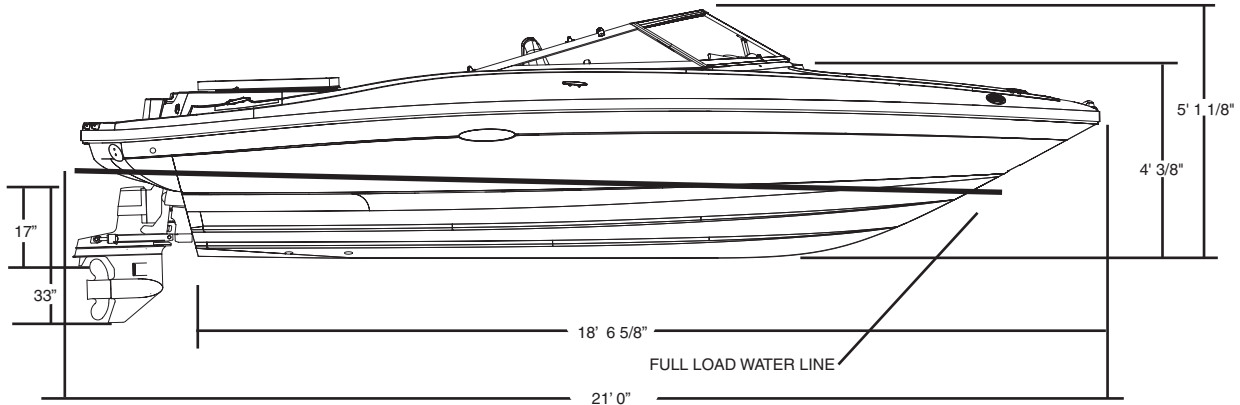

### 205 SPORT SPECIFICATIONS

Length overall.....	21ft./6.40m
Maximum beam.....	8ft./2.44m
Bow to transom/keel intersection.....	18ft. 6 in./5.65m
Draft (stern drive down).....	33"/84cm
(stern drive up).....	17"/43cm
Fuel capacity.....	37 gal./140 Liters
Dry Weight.....	3,265 lbs/1,481 kg
Dead rise.....	20°

BOAT DIMENSIONS AND CLEARANCES  
(CONT'D)(FIG. 3.2)

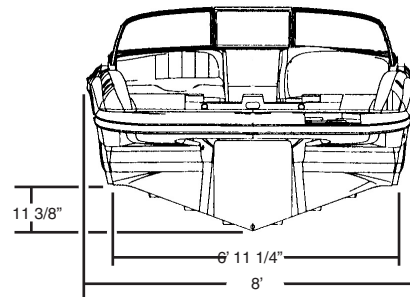

## 5. FUNCTION AND LOCATION OF THROUGH-HULL CUTOUTS

STARBOARD THROUGH-HULL CUTOUTS  
(FIG. 4.1)

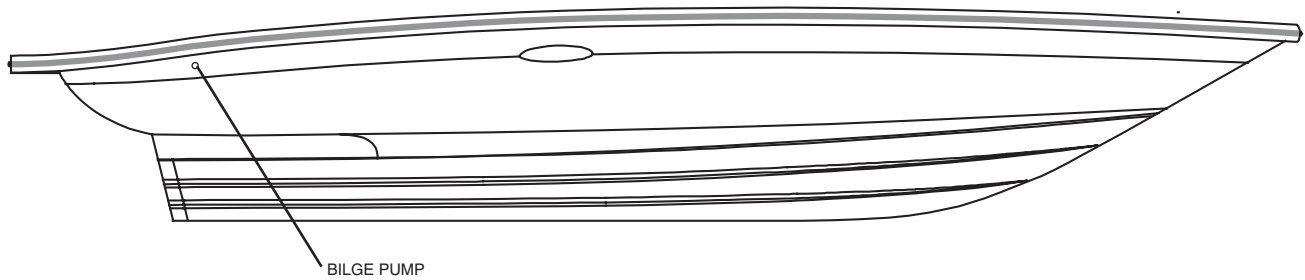

PORT THROUGH-HULL CUTOUTS  
(FIG. 4.2)

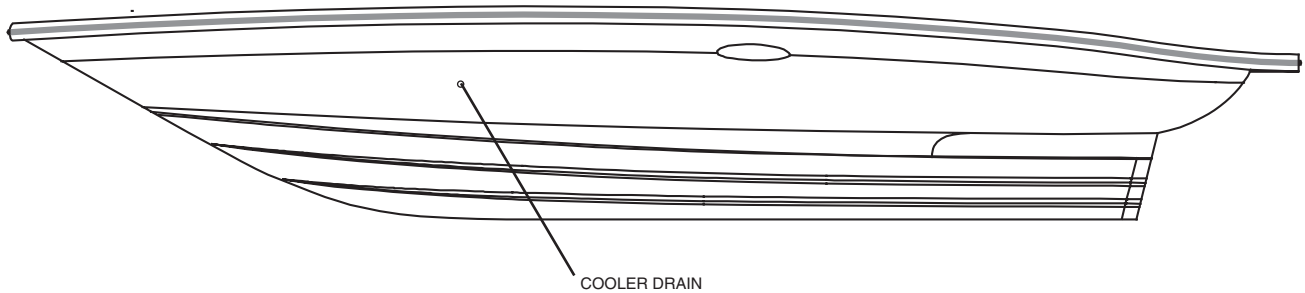

BILGE THROUGH-HULL CUTOUTS  
(FIG. 4.3)

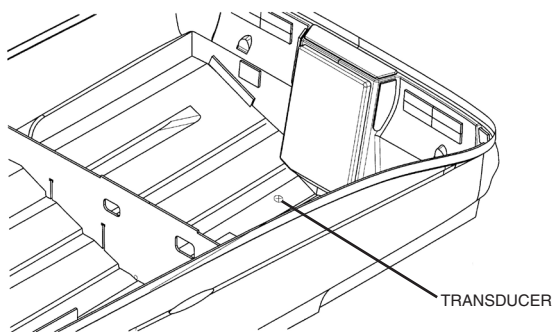

TRANSOM THROUGH-HULL CUTOUTS  
(FIG. 4.4)

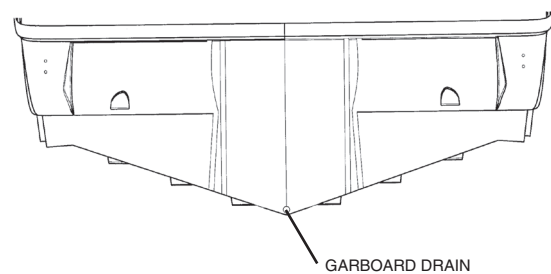



# 205 SPORT OWNERS MANUAL

## 6. HELM, GAUGE & SWITCH LAYOUT

HELM

(FIG. 5.1)

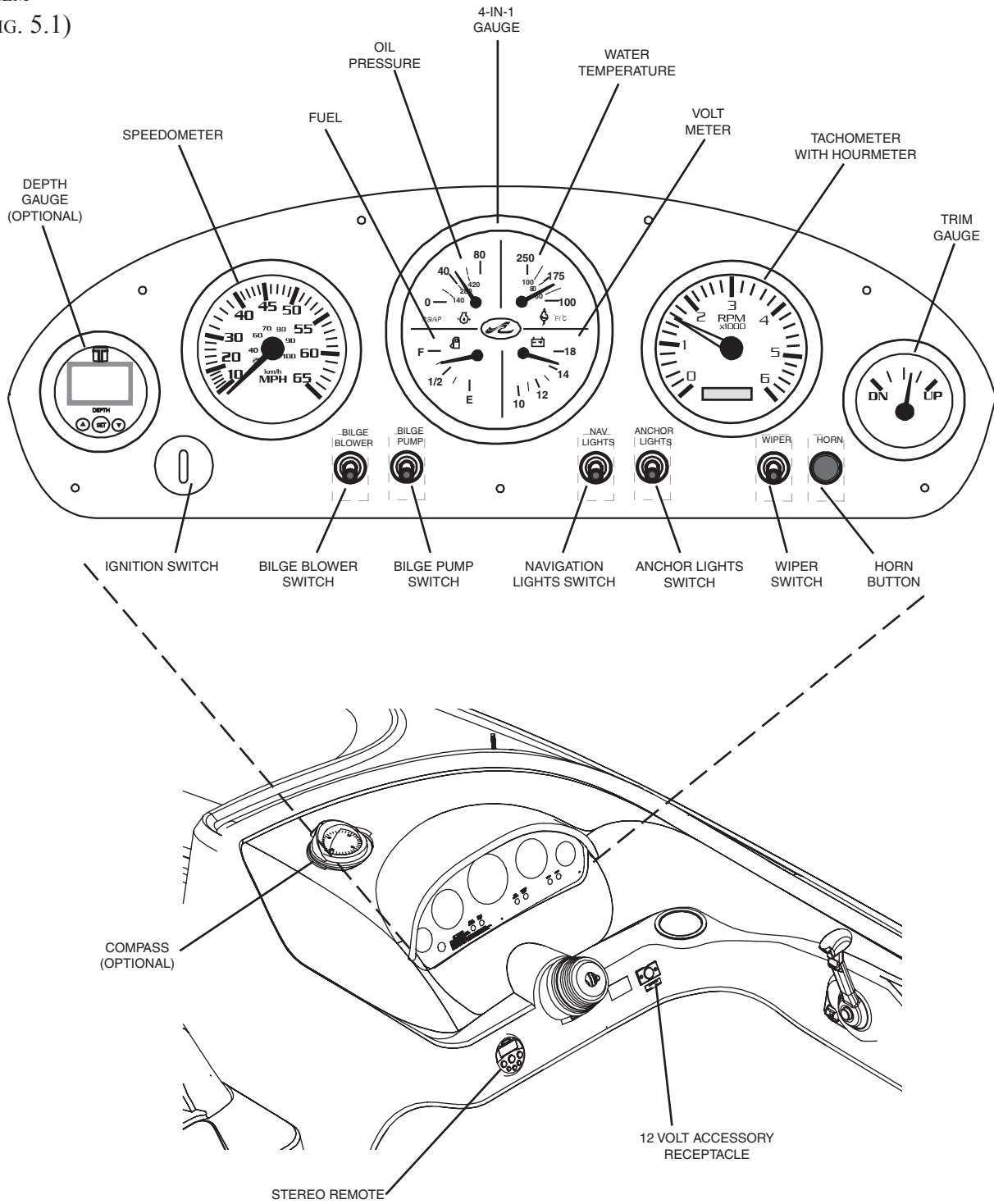

# 205 SPORT OWNERS MANUAL

## 7. DECK LAYOUT

GENERAL LAYOUT  
(FIG. 6.1)

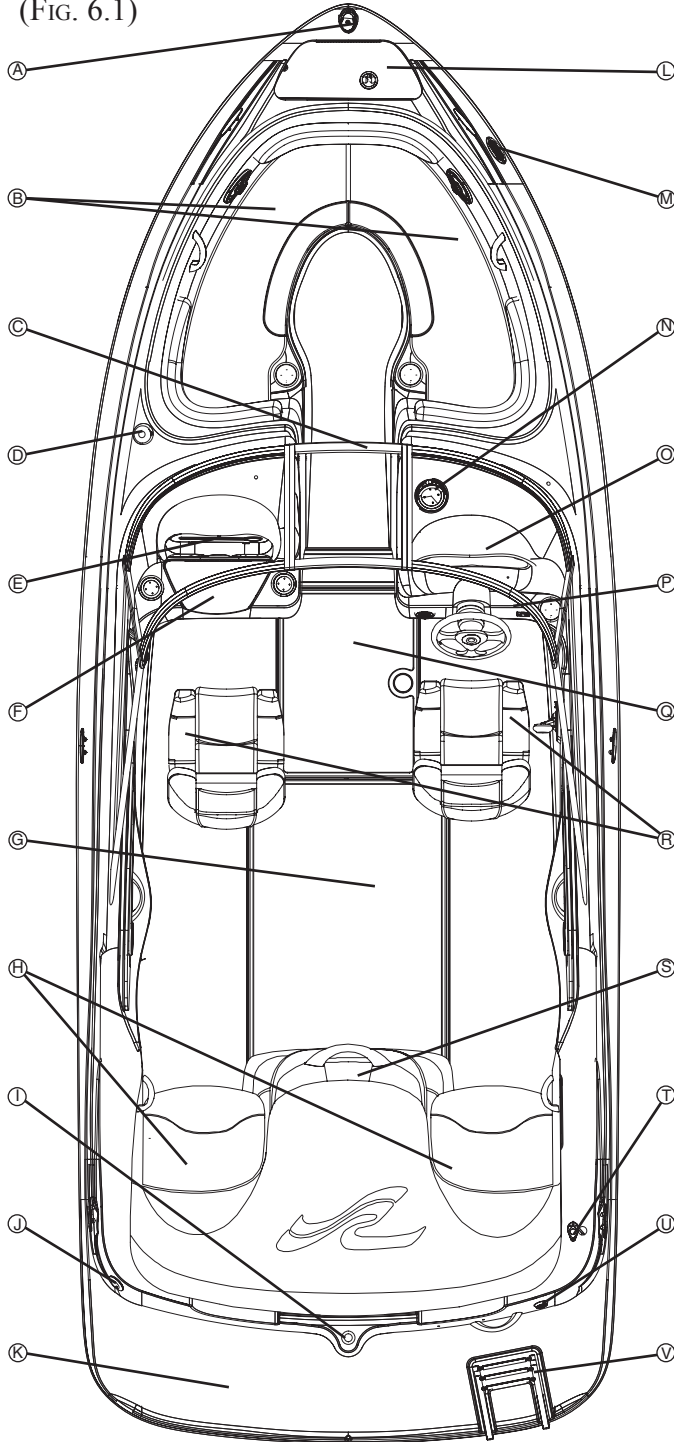

OPTIONAL SEATING PLANS

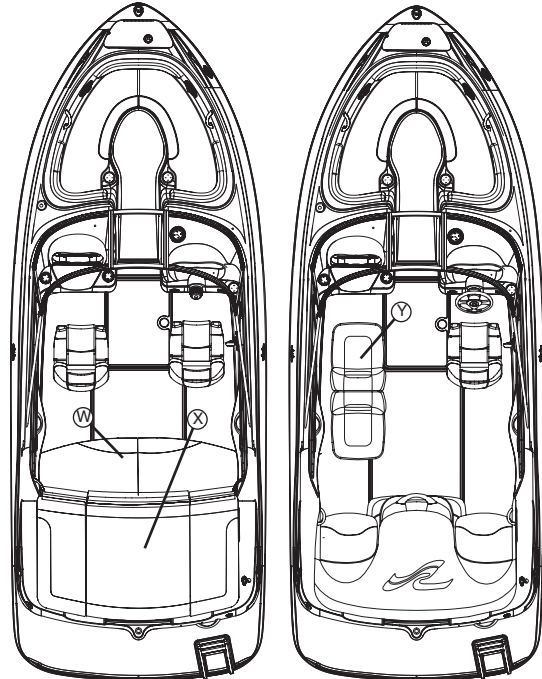

2 BUCKET SEATS; TRANSOM  
BENCH SEAT; SUNPAD

BUCKET SEAT; BACK-TO-BACK  
LOUNGER; 2 HI-LO JUMP  
SEATS; MOTOR BOX

- Ⓐ NAVIGATION LIGHT
- Ⓑ BOW STORAGE (UNDER CUSHIONS)
- Ⓒ WALK-THROUGH WINDSHIELD
- Ⓓ SATELLITE STEREO ANTENNA
- Ⓔ LOCKABLE GLOVE BOX (STEREO INSIDE)
- Ⓕ INTEGRATED INSULATED COOLER
- Ⓖ FUEL TANK ACCESS HATCH
- Ⓗ AFT JUMP SEATS
- Ⓛ POP-UP SKI TOW EYE
- Ⓜ FUEL FILL DECK PLATE
- Ⓝ SWIM PLATFORM
- Ⓟ ANCHOR STORAGE LOCKER
- Ⓜ HORN
- Ⓝ COMPASS (OPTIONAL)
- Ⓞ CONTROL STATION
- Ⓟ 12 VOLT RECEPTACLE
- Ⓠ SKI/WAKEBOARD STORAGE
- Ⓡ BUCKET SEAT
- Ⓢ MOTOR BOX
- Ⓣ NAV/ANCHOR LIGHT
- Ⓤ STEREO REMOTE (OPTIONAL)
- Ⓡ SWIM LADDER
- Ⓡ TRANSOM BENCH SEAT (OPTIONAL)
- Ⓡ SUN PAD
- Ⓡ BACK-TO-BACK LOUNGER (OPTIONAL)



# 205 SPORT OWNERS MANUAL

## 8. CLEATS

Cleats must not be used for lifting the boat; they are intended for docking or mooring use only.

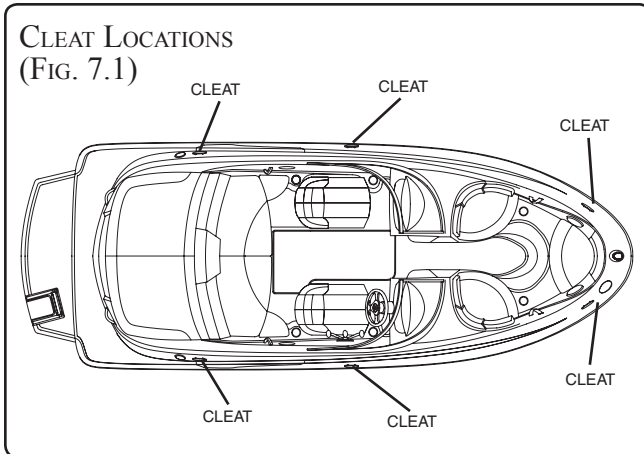

## 9. NAVIGATION AND ANCHOR LIGHTS

See General Information Manual for a detailed explanation of the anchor lights.

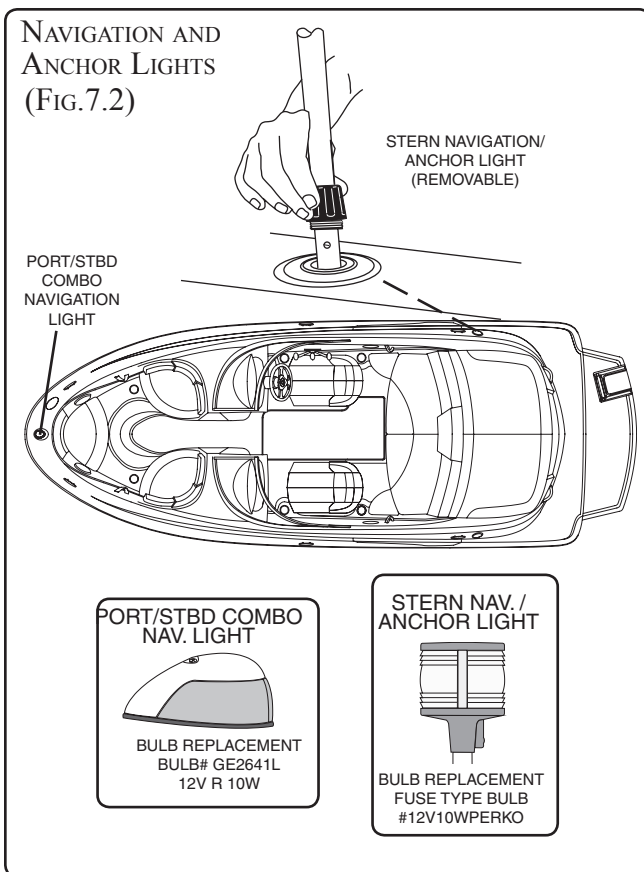

## 10. BILGE LAYOUT

BILGE LAYOUT  
(FIG. 7.3)

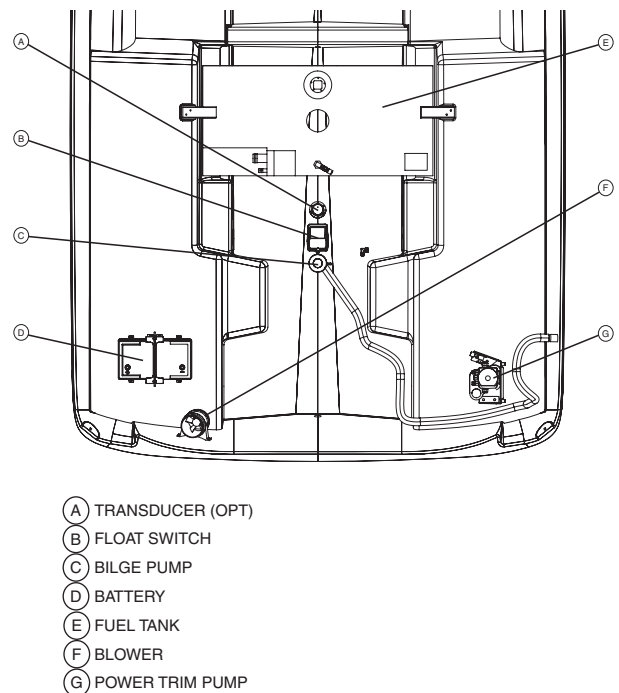

## 11. FUEL SYSTEM

The 205 Sport standard gasoline fuel system consists of a 37 gallon (140 liter) fuel tank, fuel tank vent, anti-siphon valve, engine fuel supply line and fuel fill.



# 205 SPORT OWNERS MANUAL

## 12. ENTERTAINMENT SYSTEM

The entertainment center equipment options may vary from boat to boat.

The entertainment system on the 205 Sport consists of a 12V AM/FM radio, single CD unit and a remote MP3 port located in the glove box on the port dash. The system includes two (2) waterproof speakers. The optional Premier Stereo upgrade also includes an amplifier, two (2) additional speakers and a digital remote control.

REFER TO OWNER'S MANUAL PACKET FOR INSTRUCTIONS AND WARRANTY INFORMATION.

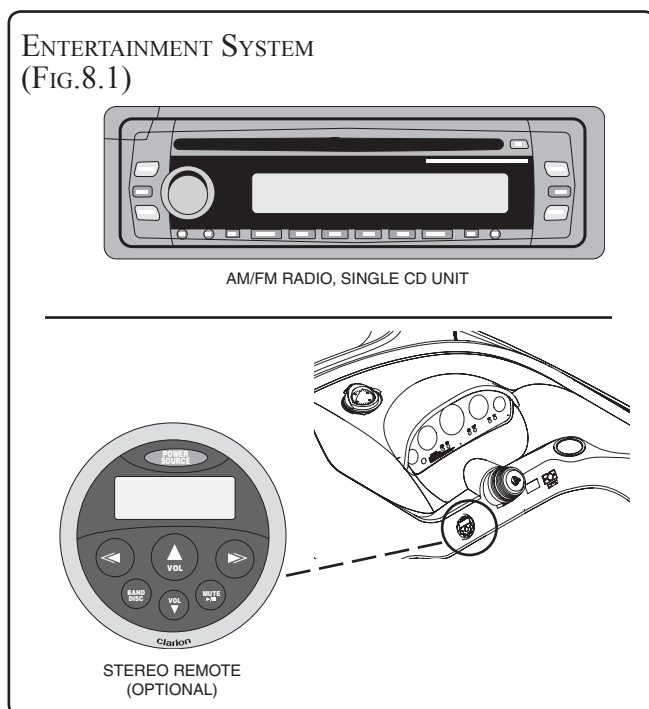

## 13. CANVAS

The following canvas pieces are available individually as options:

- Sunbrella® Bimini Top w/ Boot
- Cockpit and Tonneau Covers w/ storage Bag
- Travel/Storage Cover

### DANGER

Exhaust fumes from engines contain deadly carbon monoxide gas (CO). Boats enclosed with canvas or with poor ventilation are most likely to collect fumes.

CO sickness symptoms include headache, nausea and dizziness. Do not mistake these symptoms for sea sickness.

Ventilate boat. See Section 1.4, Carbon Monoxide, for more details.

Do not use the rear (aft) curtain while engine is running or boat is moving.



## 14. WATER SPORTS TOWER

If equipped, the water sports tower provides a raised attach point (ski tow pylon) for the ski rope. The high attach point enables the skier to perform a wide variety of skills not capable with the lower transom attach point.

The tower attach point is intended for use only when towing a single skier. If you are towing multiple skiers or water toys carrying more than one person use only the transom attach point. The tower attach point is NOT intended for towing inflatables.

### **! WARNING**

DO NOT USE TOWER FOR PULLING INFLATABLES. Use water sports tower for single skier/wakeboarder only. Use ski tow or stern eyes on transom for all other tow behind sports. Heavy loads could collapse tower causing personal injury.

### **! WARNING**

DO NOT USE WATER SPORTS TOWER FOR TOWING ANOTHER BOAT OR BEING TOWED. TOWER COULD COLLAPSE AND CAUSE INJURY. SEE OWNER'S MANUAL FOR INSTRUCTIONS ON TOWING.

WATER SPORT TOWER (OPTIONAL)  
(FIG. 9.1)

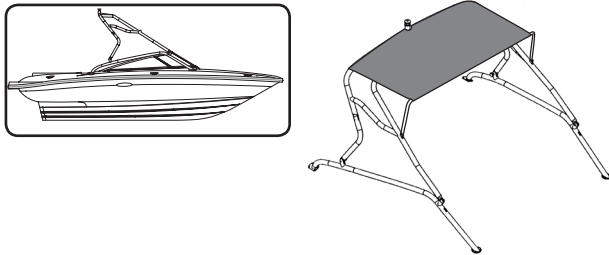

## 15. SWIM PLATFORM AND LADDER

The swim ladder is located on the stbd side of the swim platform. Unfold the ladder and drop into the water to assist swimmers in boarding the vessel.

SWIM PLATFORM LADDER  
(FIG. 9.2)

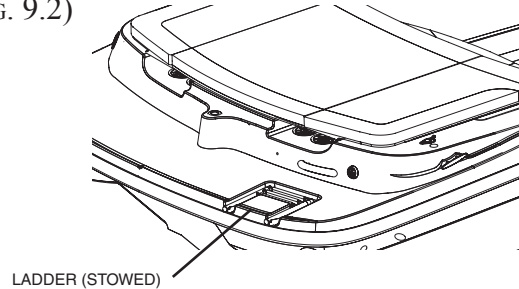

### **! DANGER**

TO AVOID RISK OF SERIOUS INJURY OR DEATH SHUT OFF ENGINE WHEN NEAR SWIMMERS OR PRIOR TO USING SWIM PLATFORM AND BOARDING LADDER.

## 16. ELECTRICAL SCHEMATICS

This owner's manual contains electrical schematics and wiring harness illustrations for your boat. These electrical schematics were generated by electrical CAD designers at the engineering division for technical reference and service technicians. Sea Ray® does not recommend that you attempt to work on the boat's electrical system yourself. Instead, we recommend that you take your boat to your authorized Sea Ray® dealer for service. Sea Ray® reserves the right to change or update the electrical system on any model at any time without notice to the consumer and is NOT obligated to make any updates to units built prior to changes.

# 1. ELECTRICAL SCHEMATICS

DC Wiring Diagram (1 of 2)  
(Fig. 10.1)

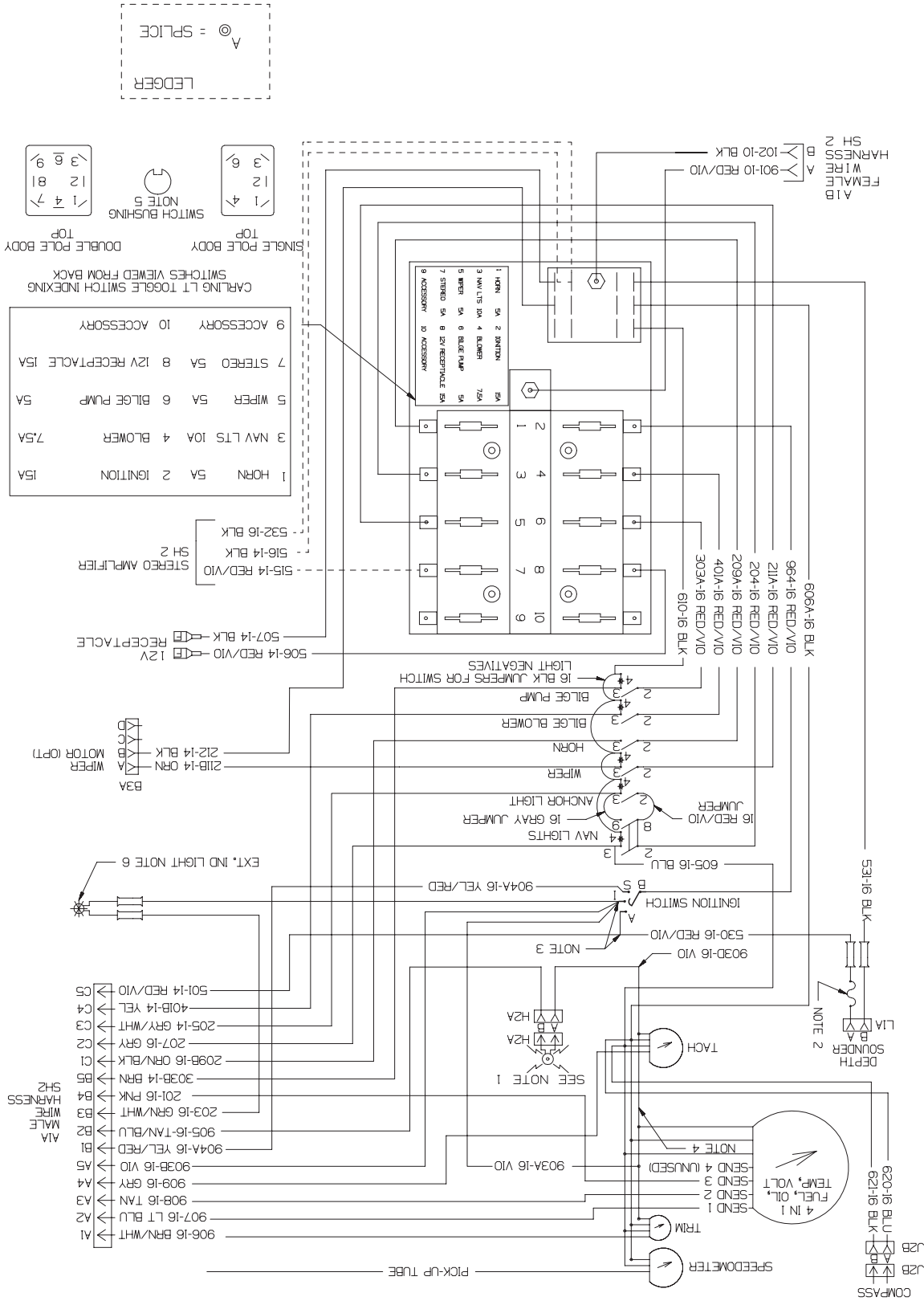

**Warning:**  
DO NOT attempt to work on the electrical system of this boat without professional assistance.



# ELECTRICAL SCHEMATICS (CONTINUED)

DC WIRING DIAGRAM (2 OF 2)  
(Fig. 11.1)

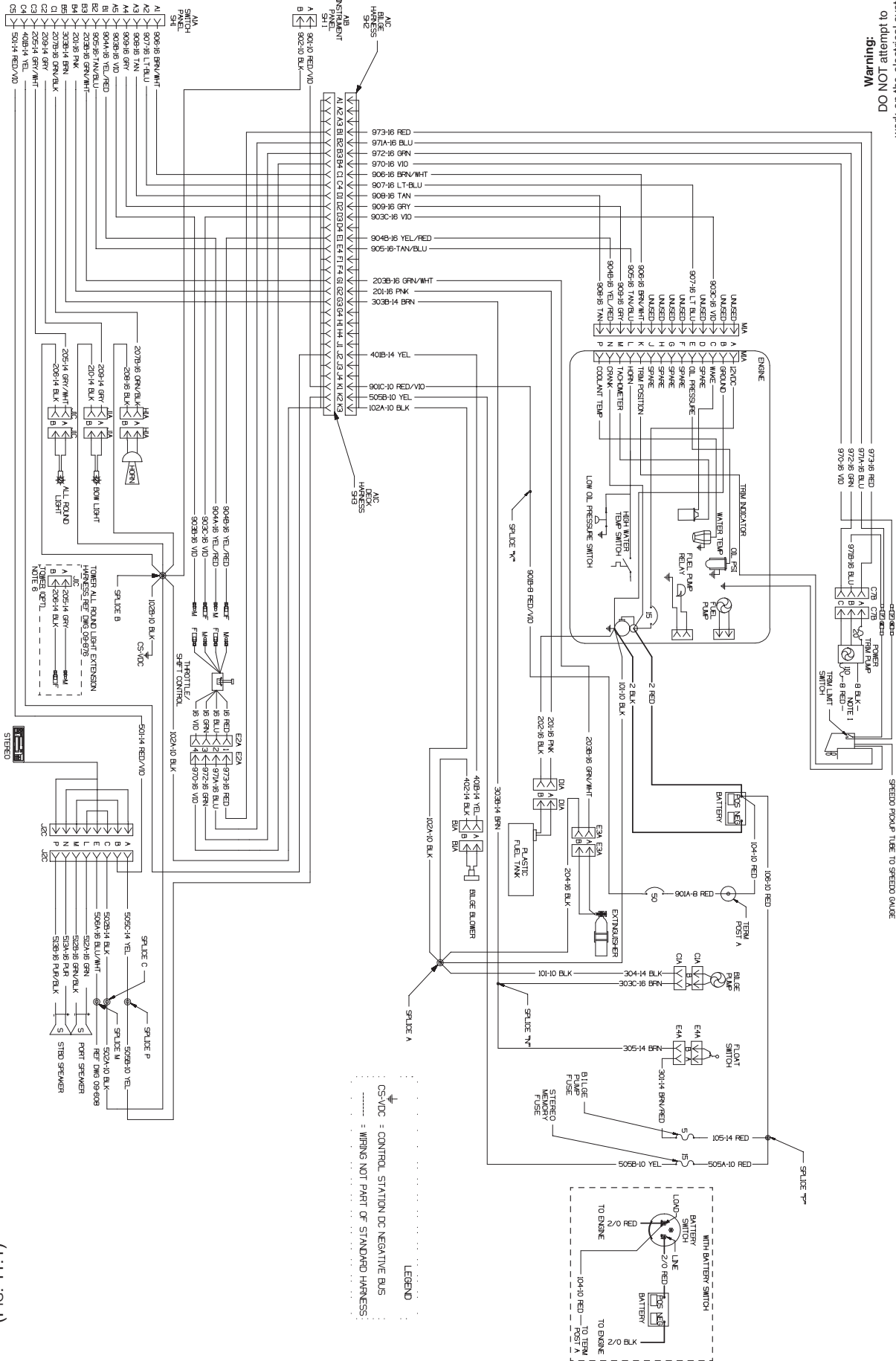

THIS PAGE INTENTIONALLY LEFT BLANK

**Warning:**  
DO NOT attempt to  
work on the electrical system  
of this boat without professional  
assistance.





---

# INDEX

---

<b>A</b>		<b>L</b>	
Anchor Lights.....	7	Load Capacity.....	1
<b>C</b>		<b>N</b>	
Canvas.....	8	Navigation Lights .....	7
Clearances .....	3		
Cleats .....	7	<b>P</b>	
<b>D</b>		Passenger Locations .....	1
Deck Layout.....	6	<b>S</b>	
Dimensions.....	3	Safety Label Locations .....	2
<b>E</b>		Swim Platform .....	9
Electrical Schematics .....	9	Switch Layout .....	5
<b>F</b>		<b>T</b>	
Fuel System.....	7	Through-Hull Cutouts .....	4
<b>G</b>		<b>W</b>	
Gauge Layout .....	5	Water Sports Tower .....	9
<b>H</b>			
Helm Layout.....	5		



THIS PAGE LEFT INTENTIONALLY BLANK

*Sea Ray* 