

Sea Ray

36 SUNDANCER

2006



HIGHLIGHTS

SPECIFICATIONS

Overall length w/std. swim platform	39'	11.89 m
Beam	12'6"	3.81 m
Draft (inboards)	37"	94 cm
Dry weight	18,500 lbs	8,392 kg
Fuel capacity	250 gal	946.2 L
Water capacity	55 gal	208.2 L
Holding tank	35 gal	132.5 L
Dead rise	21°	21°

- Mercury Installation Quality Certification – standard 2-year limited engine warranty
- Standard SmartCraft™ Instrumentation and System View
- Fiberglass sport spoiler with overhead lighting and stainless steel grab rails
- Swivel bucket helm seat with flip-up thigh-rise bolster
- Companion bench with molded fiberglass storage
- Electrically actuated engine compartment hatch
- Standard generator with sound shield
- Standard LCD flatscreen TV with DVD in salon and forward stateroom
- 12V AM/FM single CD with six-disc CD changer, eight (8) speakers and digital cockpit remote control
- Sirius® satellite receiver with antenna, includes 6-months of activation on Sirius Satellite Radio
- Innerspring mattress is standard in forward stateroom
- Ultraleather HP™ standard on all interior seating
- Standard anchor washdown
- Sea Ray Owners Club™ membership

FEATURES AND STANDARD EQUIPMENT

HULL & DECK FEATURES

Bottom Paint
Bow Rail, Stainless Steel w/Welded Stanchions
Canvas Colors (Navy, Green, Tan, Black)
Cleats, Custom Sea Ray® Thru-Bolted - Stainless Steel (8)
Deck Fill Plates, Stainless Steel
Drain Plug, Brass-Threaded - Garboard
Gel Coat, Arctic White
Graphics, Striping
Handrails, 316 Stainless Steel
Hatch, Deck Vent - Translucent w/Locks & Sky Screen Cover (20x20)
Light, Stern
Lights, Navigation
Portlights, Stainless Steel (4 Opening)
Resin, High-Performance Vinyloster Rub Rail, PVC w/Stainless Steel Insert
Sylights, Circular - Salon (3)
Swim Platform, Extended w/Concealed Stainless Steel
Three-Step Swim Ladder w/Integral Grab Handle
Thru-Hull Fittings, Stainless Steel
Toe Rail, Molded Fiberglass - Deck Vent System, Engine Room - Integral

Windshield, Tempered/Tinted Curved
Glass w/Stainless Steel Frame, Electric Front Vent & Stainless Steel Supports
Windshield Washer System
Windshield Wipers

Canvas (Sunbrella®):

Aft Curtain
Aft Sunshade
Bimini Top w/Boot & Vertical Storage
Canvas Storage Bag
Front Curtains
Side Curtains

Windlass System:

Anchor, Galvanized
Anchor Chute, Stainless Steel
Anchor Rope/Chain Storage w/Hatch
Anchor Washdown Spigot
Windlass, Rope/Chain w/Foot Switches (Lofrans® Project 1,000 Low Profile)

Certifications:

Meets Applicable USCG & ABYC Standards
NMMA Certification
Mercury Installation Quality Certification

COCKPIT FEATURES

Beverage Holders (10)
Carpet Liner, Snap-In
Door, Cabin Entry - Acrylic
Door, Transom - Acrylic
Floor Liner, Fiberglass - Self-Bailing
Handrails, 316 Stainless Steel
Hatch, Engine Room - Electrically Actuated
Ice Chest, Insulated - Built-In
Icemaker, 120V
Lighting, Indirect
Outlet, 12V Accessory
Outlet, 120V GFI Protected
Seating, Aft Bench (Removable)
Seating, Aft-Facing w/Molded Fiberglass Storage Base
Seating, Companion Bench

w/Molded Fiberglass Storage Base
Seating, Helm - Bucket w/Flip-Up
Thigh-Rise Bolster, Armrests & Heavy-Duty Pedestal w/Slide, Swivel & Pneumatic Vertical Adjustment
Sport Spoiler, Molded Fiberglass (Seamless) w/Overhead Lighting & Stainless Steel Grab Rails
Steps, Boarding - Molded-In Storage, Side Panels
Table, Cockpit w/Sun Pad Filler Cushions
Wet Bar w/Sink, Faucet, Stainless Steel Handrail, Trash Receptacle & Storage Cabinet

CABIN FEATURES

Carbon Monoxide Monitors
Carpet, Deep-Pile BCF - 44-Ounce
Carpet Runners, Interior (Sunbrella)
Curtains & Drape Trim
Handrails, Elliptical Stainless Steel
Interior Finish - Blossom Cherry
Lighting, 12V Halogen
Outlet, 12V Accessory
Outlets, 120V GFI Protected
Outlets & Switch Plates - Satin Nickel Finish

Pillows, Accent
Stereo, Clarion® 12 AM/FM Single CD, Sirius® Satellite Receiver w/Antenna, 6-Disc CD Changer, Amplifier, Subwoofer, Speakers (8), Digital Cockpit Remote Control & Speaker Selector Switches
Steps, Entryway - Wood w/Aluminum Pedestal
Storage, In-Floor

TV, 15" Flatscreen LCD (120V)
w/Remote DVD Player, Coax Outlet & Gain Control Panel

Salon:

Lighting, 12V Indirect
Seating, Crescent-Shaped Sofa w/Storage Below - Converts to Bed (Ultraleather HP™)
Storage, Gunwale Cabinet
Table, Salon w/Designated Storage

Galley:

Countertop, Solid Surface, Sink, Single-Lever Grohe® Faucet & Sink Cover
Freezer, Under Counter - Dual Voltage 120V/12V
Handrail, Stainless Steel
Microwave, 120V
Power Vent, 12V, Stainless Grill
Refrigerator - Under Counter Dual Voltage - 120V/12V
Storage, Upper & Lower w/Designated Plate Storage & Cutlery Insert
Stove, 120V Recessed - Two-Burner w/Cover
Trash Receptacle

Forward Stateroom:

Berth, Full-Size (Island-Style)
w/Innerspring Mattress
Door, Privacy - Sliding Pocket
Hanging Locker w/Mirrored Door - Starboard
Mirrored Rope Locker Bulkhead Storage, Gunwale Cabinets
TV/DVD Combo, 15" LCD Flatscreen w/Remote & Coax Outlet

Mid-Stateroom:

Curtain, Privacy w/Dedicated Storage
Mirrored Bulkhead - Aft
Portlights, Stainless Steel (1 - Opening)
Seating, Conversation Pit - Converts to Double Berth w/Slide-Out Base Storage, Cabinets

Head/Shower:

Door, Privacy - Access from Salon Head (VacuFlush®)
Head, Enclosed - Full Fiberglass w/Shower & Curved Acrylic Doors
Power Vent, 12V, Stainless Grill
Storage, Medicine Cabinet w/Mirrored Door
Vanity w/Sink, Faucet & Storage Below

TECHNICAL FEATURES

Control Station:

Alarms, Engine - Oil, Water & Transmission Oil
Alarms, High-Water - Bilge
Compass
Emergency Start System - Engines
Gel-Coated Dash - Tan
Horns (Concealed) - Dual Trumpet
Instrument Panels - High-Gloss Burl
Shift & Throttle Controls w/Gold Knobs

SmartCraft™ Diagnostics:

- Instrumentation, Custom Sea Ray SmartCraft 4-in-1 Multigauges (2) w/Low-Glare Blue Night Lighting & Chrome Bezels (Includes: Fuel Level, Oil Pressure, Voltmeter, Water Temperature)
- SmartCraft System View (Includes: Air & Water Temperature, Combined Fuel Flow/Range, Depth, Engine Alarms/Hourmeters, Engine Synchronizer, GPS Interface & Raymarine 125 GPS Antenna, System Maintenance Records)

Steering, Hydraulic
Steering, Tilt Wheel
Steering Wheel, Wood-Accent
Switch Panels (Backlit) - High-Gloss Burl
Switches, Illuminated Weatherproof
Rockers & Dimmer Control
Systems Monitor, Digital LCD - for Engine Diagnostics & Pump Monitoring

Electronics:

Electronics Circuit, 50 Amp/12V
VHF Radio & 8' Fiberglass Antenna

Electrical Systems:

Batteries (4) w/Trays, Battery Overcurrent Protection & Mounts
Battery Charger/Converter, 120V/40 Amp/12V

Panel, DC Main Breaker
Panel, Main Distribution - AC
Panel, Main Distribution - DC
Shore Power, Dual 30 Amp/120V/60 Cycle w/Zinc Savers & 50' Cords & Adapters
TV/Phone Inlet w/TV Antenna, TV Shore Cord & Phone Shore Cord
Wiring, Color-Coded w/Chafe Protection

Generator:

Remote Start w/Muffler, Freshwater Cooling, Fuel Filter, Seacock, Seawater Strainer, 120V/60 Cycle 7.3 kW Kohler® Gas w/Sound Shield
(Generator manufacturer and size may vary due to product availability.)

Air Conditioning/Heating:

Zone-Controlled Reverse-Cycle System (16,000 BTU)
Custom Integral Vent System

Engine Room:

Bilge Pump, 12V Automatic
Bilge Pumps, 12V Automatic High-Water (1 Bilge, 1 Cabin)
Blowers, 12V Bilge (2)
Fire Suppression System - Automatic w/Manual Pull
Gel-Coated Engine Room, Oyster Insulation, Engine Room - 2" w/Vinyl Barrier
Lighting, 12V
Steps, Engine Room Access - Diamond Plate

Fuel System:

Fuel Filters, Remote - Diesel (Racor®)
Fuel Lines, USCG - Type A-1
Fuel Tanks, Aluminum w/Electric Shutoff Valves & Electric Sending Units

TECHNICAL FEATURES (CONT.)

Water System:

Freshwater Washdown Spigot - Transom
Manifold System w/Shutoff Valves
Pressure Water System w/12V Pump
Shower, Cockpit - Hot & Cold
Water Heater, 120V (6-Gallon)
Water Inlet, Dockside
Water Tank (55-Gallon)

Waste Systems:

Head System (VacuFlush®)
Holding Tank Level Indicators - MDP & Head
Holding Tank w/Dockside Pump-Out (35-Gallon)
Sump Box w/Pump - Automatic

Underwater Gear:

Bonding System w/Zinc Hull Plate
Propeller Shafts, 1 1/2" Stainless Steel
(2) - Aquamet 19
Propellers, Nibral 4-Blade Cup
Rudders, Manganese-Bronze w/Stainless Steel Posts
Seacocks on all Underwater Fittings
Seawater Strainers
Shaft Logs, Dripless w/Extra Seal Carrier Kit
Struts, Manganese-Bronze
Trim Tabs, Hydraulic
Underwater Exhaust - Patented

STANDARD PROPULSION

T-VD-8.1 S Horizon MerCruiser®
Gasoline V-Drives
(T-370 hp - 276 kW)

OPTIONS AND ACCESSORIES

OPTIONAL PROPULSION

Twin Gasoline V-Drives:

T-VD-8.1 S HO MerCruiser
(T-420 hp - 313 kW)

Twin Diesel V-Drives:

T-VD-Yanmar 6LP-STP
(T-306 hp - 228 kW)
(SmartCraft™ Systems N/A on Diesel Engine Applications.)

GENERATOR OPTIONS

220V/50 Cycle (Int'l) 6.0 kW Kohler® Gas
120V/60 Cycle 8.0 kW Kohler Diesel
220V/50 Cycle (Int'l) 6.5 kW Kohler Diesel

(Generator manufacturer and size may vary due to product availability.)

ELECTRONICS OPTIONS

Northstar Individual Options:

Northstar 6000i Radar/ GPS/
Chartplotter w/8.4" Color LCD
Auxiliary Northstar 6000i GPS/
Chartplotter w/8.4" Color LCD
Northstar 491 Fishfinder (only available w/6000i)

Raymarine® Individual Options:

Raymarine Autopilot (Raypilot ST-7001+)
Raymarine Radar, C80 Chartplotter (8" Color LCD w/4 kW Open Array)
Raymarine Fishfinder, DSM 300 (Only Available w/C80 Radar/Chartplotter)

INDIVIDUAL OPTIONS

Bow Thruster
Canvas, Dash Cover
Colored Hull (Blue)
Flooring, Teak - Cockpit
Gray Water System
Macerator w/Seacock Interlock System
Power Steering
Refrigerator, 120V/60 Cycle - Cockpit (In Lieu of Std. Ice Maker)
Rod Holders (2)
Spotlight, w/Dual Halogen Bulbs Remote-Controlled

Sun Pad w/Stainless Steel Deck Runners - Forward Deck
Synchronizer, Engines (w/Gas or Diesel)
TV, 13" Flatscreen w/DVD - Mid-Stateroom
Vacuum System, Central - 120V/60 Cycle (Beam®)
Windlass, All-Chain (In Lieu of Std. Rope/Chain)
(Lofrans® Project 1,000 Capstan)
Yacht Flag & Flag Pole
CE Option

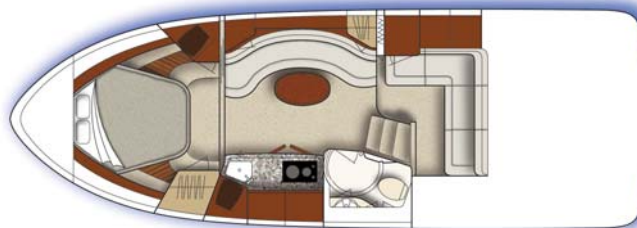

Cabin Layout



Cockpit Layout

NOTE: Boats which are ordered with 220V/50 Cycle Electrical Systems will be installed with the appropriate appliances in the corresponding voltage.



36 SUNDANCER

2006

For those who have always dreamed of owning a Sea Ray Sport Yacht, the dream is now within reach. The 36 Sundancer offers plenty of seating for your friends. Her cabin sleeps six. She has a full galley, a flat screen LCD TV w/DVD in the cabin and in the forward stateroom, a wet bar, and a quiet step-down conversation area that converts to a private stateroom. And her twin VD-8.1 S Horizon MerCruiser® gasoline V-drives give you the power to go as far as your dream will take you.



The captain has a bucket seat with flip-up thigh-rise bolster. The control station features custom Sea Ray SmartCraft™ Instrumentation, illuminated weatherproof rockers and dimmer control, and a wood-accent tilt-steering wheel with hydraulic steering.



For dining or games, add the table between the aft cockpit seats. Lower the table, pile on the custom cushions from their dedicated storage compartment, and the entire area becomes a large sun pad. The wet bar has a sink and icemaker, as well as a built-in insulated ice chest, trash receptacle, and large storage cabinet.



A faux granite countertop with sink and Grohe® faucet, recessed two-burner stove, refrigerator/freezer, and microwave complete the galley.



The step-down conversation area converts to a private stateroom with double berth and privacy curtain.



The private head compartment is easily accessible. It features a full fiberglass shower with curved acrylic doors, a vanity with sink and storage, a medicine cabinet, and a VacuFlush® head.



The salon has a beautiful crescent Ultraleather HP™ sofa that converts to a double bed. Electronic entertainment is available via the flatscreen LCD TV with DVD player.

Sea Ray Boats, 2600 Sea Ray Blvd., Knoxville, TN 37914. For information call 1-800-SRBOATS or fax 1-636-326-3282. Internet address: <http://www.searay.com>
 Note: Not all accessories shown in pictures or described herein are standard equipment or even available as options. Options and features are subject to change without notice. Not all model year boats may contain all the features or meet the specifications described herein. Confirm availability of all accessories and equipment with an authorized Sea Ray dealer prior to purchase. Printed in the U.S.A. June 2005 ©Sea Ray Boats.